



DREAMERS,
IMMIGRATION,
& SOCIAL JUSTICE

ADVANCING A GLOBAL LATINA/O PSYCHOLOGY AGENDA



6TH BIENNIAL CONFERENCE
OCTOBER 23 -25, 2014
ALBUQUERQUE, NM

EDUCATION



BE THE CHANGE

DESCUBRE TODAS LAS OPCIONES QUE TIENES A TU ALCANCE



TheChicagoSchool[®]
of Professional Psychology

EDUCATION INNOVATION SERVICE COMMUNITY

THECHICAGOSCHOOL.EDU

**LOCALES MÚLTIPLES EN
TODO EL PAÍS**

UNA ENTIDAD SIN FINES DE LUCRO

800-721-8072



TABLE OF CONTENTS

Welcome	4
Our Conference Logo & its Artist	6
Conference Organizers	7
Scientific Program Reviewers	8
Keynote Speakers	10
Conference Sponsors	14
NLPA Mission & its Leadership Council	15
NLPA Presidential Citations	17
NLPA 2014 Awards & Recognitions Descriptions	18
NLPA 2014 Awardees	20
The Alliance of National Psychological Associations for Racial and Ethnic Equity	25
CNPAAEMI Leadership Development Institute (CLDI)	26
CE Process	27
Thursday & Friday Schedule at a Glance	29
Conference Presentation Descriptions	30
Thursday & Friday Program	31
Saturday & Sunday Schedule at a Glance	57
SIGs	58
Saturday & Sunday Program	59
Attendee Directory	81
Notes	95
Hotel Map	98



¡BIENVENID@S!

DEAR NLPA 2014 CONFERENCE PARTICIPANTS



On behalf of the National Latina/o Psychological Association (NLPA) Executive Committee, its Leadership Council, and the NLPA2014 conference committee, we welcome you to NLPA's 6th Biennial *Conferencia!* What you will experience over the next few days is the labor of love of many people, led by the two of us. It takes a *familia* to execute a conference, and we are that *familia*. The journey to the conference started two years ago, with the appointment of Cynthia as the Conference Chair and Andrés joining her as NLPA President-Elect at that time. We committed ourselves to a shared, participatory process, consulting our NLPA membership and Leadership Council at every major step of that journey. As such, we sought to staff all committees related to the Conference, including the Scientific Program Committee, with at least one ECP member, one student member and one professional member in order to mentor new leaders in our organization. Moreover, we built a close relationship with the New Mexico Psychological Association resulting in the commitment to hold consecutive conferences. Furthermore, we embraced the opportunity to welcome the CNPAAEMI Leadership Development Institute (CLDI) training to our conference, as well as the retreat meeting for the Alliance of National Psychological Associations for Racial and Ethnic Equity which brings the presidents and representatives of the four National Ethnic Minority Psychological Associations and of the American Psychological Association to our conference.

The theme of our conference is DREAMers, Immigration, and Social Justice: Advancing a Global Latina/o Psychology Agenda; *DREAMers, Inmigración y Justicia Social: Avanzando una Agenda Global de la Psicología Latina*. The conference theme is closely related to this year's presidential initiative on international engagement, and both are addressed in a sizable number of sessions identified in the content code column of the program. Similarly, programming directed at students, ECPs, practitioners, researchers, educators, and advocates are also identified through this column. The conference logo seeks to capture the conference theme in a visual manner; we thank Melody Capielo, graphic designer, for her artistic vision in bringing our theme to life.

Our conference begins the evening of Thursday, October 23rd, with a formal *Bienvenida* and cocktail reception with live entertainment. On Friday, October 24th, the conference starts early with our Traditional Healers Convocation and is followed by a full day of scientific programming with keynotes by psychologist Dr. Isaac Prilleltensky and author Dr. Ana Castillo. We will end the day with We DREAM, a cultural event led by nationally recognized DREAMer and activist Gaby Pacheco. On Saturday, October 25th, conference attendees will have another



full day of scientific programming with a keynote by psychologist Dr. Carola Suárez-Orozco. We close the day with the *Noche de Gala: Awards Dinner & Dance*. On the morning of Sunday, October 26th, we will participate in a community engagement activity at *Los Jardines Institute* (a community garden in the South Valley of Albuquerque). Throughout the conference we will have talented artisans from the local Native American and Latina/o communities as well as over 300 book titles to peruse in the bookstore inside Alvarado A, which is also where book signings by acclaimed authors will take place.

We thank all the people who have been directly involved with the conference, as well as our sponsors and volunteers; they have made this conference possible. Moreover, we thank every one of you for contributing to the conference through your scholarship and participation. Your commitment to our *querida* NLPA is much appreciated. Our efforts do not mean much without your presence and contribution; the conference could not happen without you.

We now invite you to the dialogue and exchange that make conferences so worth it, the opportunity to socialize with colleagues and colleagues-in-training, renew friendships, and start new ones. We encourage you to take advantage of the multiple opportunities to share and to learn so we can better serve and advocate for our *gente*, and to celebrate our students and ECPs as they are our future and the future of Latina/o psychology. Please, join us in making this conference a memorable one, and then spread the word so we can continue to build and grow our association.

Should there be anything we can do to make your experience during the conference a better one, please do not hesitate to let us know.

Enjoy it,



ANDRÉS J. CONSOLI, PH.D.
NLPA 2014 President
University of California
Santa Barbara
aconsoli@education.ucsb.edu



CYNTHIA E. GUZMÁN, PH.D.
NLPA 2014 Conference Chair
Independent Practice
cyinguzman@gmail.com



**DREAMERS,
IMMIGRATION,
& SOCIAL JUSTICE**
ADVANCING A GLOBAL LATINA/O PSYCHOLOGY AGENDA

OUR CONFERENCE LOGO & ITS ARTIST



**DREAMERS,
IMMIGRATION,
& SOCIAL JUSTICE**
ADVANCING A GLOBAL LATINA/O PSYCHOLOGY AGENDA

In line with this year's conference theme, our logo is represented by a globe dream catcher that honors the plight and aspirations of our DREAMers and symbolizes the belief that growth comes as we connect with others, the same way our Latin@ agenda strengthens as we join a global community. This agenda in turn is supported by rich and diverse cultural experiences, represented by the unifying hands. The beads depicting the main Latin@ communities also recognizes our diversity and differences, and when unified, they form the five points of a star. Finally, the feathers signify the importance of spirit in Latin@ healing and psychology.



MELODY CAPIELO was born in Ponce, Puerto Rico. in 1997 her family relocated to Orlando, Florida where she grew up. Once she graduated from high school she moved to Miami, Florida where she attended and graduated with her B.F.A in Graphic Design from Ai Miami International University of Art & Design. Since then she has worked for a magazine aimed at caregiving, an electronics company where she worked in the web department, and recently at a hotel as Senior Designer for the companies many bars, hotels and satilites.

TO CONTACT MELODY OR SEE SAMPLES OF HER WORK

PLEASE VISIT:

MELISCREATIVE.COM



CONFERENCE ORGANIZERS

Cynthia E. Guzmán, Ph.D.
Conference Chair

Andrés J. Consoli, Ph.D.
*NLPA 2014 President & Leadership
Council Representative*

Kee Straits, Ph.D.
Melinda Garcia, Ph.D.
Tai Paquin, LSAA
Tom A. Chavez
Local Arrangements Committee

Elizabeth Vera, Ph.D.
Melissa L. Morgan Consoli, Ph.D.
Cristalís Capielo, Ph.D.
Scientific Program Committee

Liz Fraga, Ph.D.
Julien Almonte
Sponsorship Committee

Dianna Marisol González, Ph.D.
Eduardo Morales, Ph.D.
Awards Committee

Tom A. Chavez
Melinda Garcia, Ph.D.
Rita Navarrete
Tonita Gonzalez
Traditional Healers Convocation

Melody Capielo
meliscreative.com
Art & Program Design

Ricardo Aguirre
Abrazo Marketing
Website & Registration

SPECIAL THANKS:

German Cadenas
for his instrumental involvement in the solicitation and procurement of our
keynote speaker, Gaby Pacheco.

Valerie Minchala, Ph.D.
for her commitment and efforts in securing scholarship funding for students to
attend the conference.

Milton Fuentes, Psy.D. & Héctor Adames, Psy.D.
for their guidance and responsiveness to our inquiries



SCIENTIFIC PROGRAM REVIEWERS

Héctor Y. Adames

*The Chicago School of
Professional Psychology*

Elizabeth Aranda

Texas Woman's University

Alinne Barrera

Palo Alto University

Anabel Bejarano

University of Miami

Lauren E. Bigham

University of Georgia

Cristalís Capielo

University of Georgia

Stephanie Carrera

Iowa State University

Saskias Y. Casanova

New York University

Virmarie Correa-Fernández

University of Texas

Edward A. Delgado Romero

University of Georgia

Melanie Domenech-Rodriguez

Utah State University

Melissa Donovick

University of Oregon

Elizabeth Fraga

Columbia University

Lynda D. Field

Suffolk University

Michelle P. Flores

*University of Illinois,
Urbana-Champaign*

Milton A. Fuentes

Montclair State University

Nallely Galvan

Federal Bureau of Prisons, FMC Carswell

Araceli Gonzalez

*University of California
Los Angeles*

David A. Gonzalez

South Texas Veterans Affairs

Roseanne Illes

Michigan State University

Regina Jean-Van Hell

Brieanne Kohrt

Emory University

Tariana V. Little

*University of Massachusetts
Medical School*

Kristina Lopez

University of Michigan

Carla E. Marin

Alexis Miranda

*Yale University School
of Medicine*



SCIENTIFIC PROGRAM REVIEWERS (CONTINUED)

Silvia L. Mazzula

Ryan Montes

*John Jay College of Criminal
Justice, CUNY*

Alejandro Morales

University of Missouri

Melissa Morgan Consoli

*University of California,
Santa Barbara*

Rachael Navarro

University of North Dakota

Lideth Ortega-Villalobos

*California State Polytechnic
University, Pomona*

Margarita Paredes

Behavioral Medicine Associates

Ezequiel Peña

Our Lady of the Lake University

Nelson Portillo

State University of New York

Sarah Rangel

SeaMar Community Health Center

Desdamona Rios

*University of Houston
Clear Lake*

Manuel Salgado

Marilu Sanchez

Loyola University Chicago

Lisa Sánchez-Johnsen

University of Illinois at Chicago

Josie Serrata

National Latin@ Network

Michelle Silva

Yale University School of Medicine

José Toro-Alfonso

Universidad de Puerto Rico

Ivelisse Torres

New Mexico State University

Lucas Torres

Marquette University



KEYNOTE SPEAKERS



DR. ISAAC PRILLELTENSKY was born in Argentina and has lived and worked in Israel, Canada, Australia, and the United States. He is Dean of Education and Human Development at the University of Miami and the inaugural Erwin and Barbara Mautner Chair in Community Well-Being. He has published seven books and over 120 articles and chapters. His interests are in the promotion of well-being in individuals, organizations, and communities; and in the integration of wellness and fairness. He is the recipient of the 2011 “Distinguished Contribution to Theory and Research Award” of the Community Psychology Division of APA. He is also the recipient of the John Kalafat Award for the

Practice of Community Psychology from the same division of APA. He is leading an interdisciplinary team developing assessments and online interventions to promote interpersonal, community, occupational, psychological, physical, and economic (I COPPE) well-being. Isaac is a fellow of the American Psychological Association and of the American Educational Research Association. In 2002 he was a visiting fellow of the British Psychological Society. Isaac is a vegan and fitness aficionado. He speaks several languages and has given keynote addresses in 23 countries. His humor columns have been published in the Miami Herald and Miami Today. His humor writings may be found on his blog, Going Wellnuts, at <http://prilleltensky.blogspot.com>.

WELLNESS AND FAIRNESS FOR ALL - BIENESTAR Y JUSTICIA PARA TODOS

FRIDAY, OCTOBER 24, 2014

9:00AM - 10:00 AM



KEYNOTE SPEAKERS



DR. ANA CASTILLO is a celebrated poet, novelist, short story writer, essayist, editor, playwright, translator and independent scholar. Castillo was born and raised in Chicago. She has contributed to periodicals and on-line venues (Salon and Oxygen) and national magazines, including More and the Sunday New York Times. Castillo's writings have been the subject of numerous scholarly investigations and publications. Among her award winning, best selling titles: novels include *So Far From God*, *The Guardians* and *Peel My Love like an Onion*, among other poetry: *I Ask the Impossible*. Her novel, *Sapogonia* was a New York Times Notable Book of the Year. She has been profiled and interviewed on

National Public Radio and the History Channel and was a radio-essayist with NPR in Chicago. Ana Castillo is editor of *La Tolteca*, an arts and literary 'zine dedicated to the advancement of a world without borders and censorship and on the advisory board of the new American Writers Museum in D.C. Castillo held the first Sor Juana Inés de la Cruz Endowed Chair at DePaul University, The Martin Luther King, Jr. Distinguished Visiting Scholar post at M.I.T. and was the Poet-in-Residence at Westminster College in Utah in 2012, among other teaching posts throughout her extensive career. Ana Castillo holds an M.A from the University of Chicago and a Ph.D., University of Bremen, Germany in American Studies and an honorary doctorate from Colby College. She received an American Book Award from the Before Columbus Foundation for her first novel, *The Mixquiahuala Letters*. Her other awards include a Carl Sandburg Award, a Mountains and Plains Booksellers Award, and fellowships from the National Endowment for the Arts in fiction and poetry. She was also awarded a 1998 Sor Juana Achievement Award by the Mexican Fine Arts Center Museum in Chicago. Dr. Castillo's *So Far From God* and *Loverboys* are two titles on the banned book list controversy with the TUSD in Arizona. Dr. Castillo is the 2013 Recipient of the American Studies Association Gloria Anzaldúa Prize to an independent scholar. She will hold the Lund-Gil Endowed Chair at Dominican University (IL) in 2014. The 20th anniversary updated edition of *Massacre of the Dreamers: Essays on Xicanisma* is being released in October 2014 by UNM Press, in time for NLPA's conference (photo credit: Claudia D. Hernández © 2014 USA).

FOR A NEW GENERATION OF DREAMERS

FRIDAY, OCTOBER 24, 2014

12-1:20 PM

BOOK SIGNING

1:30 PM - 2:20 PM



KEYNOTE SPEAKERS



MA. GABRIELA "GABY" PACHECO is a "DREAMer," a fighter, and a leader. Gaby serves as the Program Director of The Dream.US and the Director of the Bridge Project, where she functions as a national spokesperson, advocate, and strategist for addressing the plight of undocumented students (better known as "DREAMers"). She also has been an advocate of comprehensive immigration reform and for President Barack Obama's Deferred Action for Childhood Arrivals (DACA) program. As a young child, Gaby immigrated to the U.S. from Ecuador with her family and was raised in Miami, Florida. When her immigration status closed the doors of opportunity, Gaby became a local, regional and

national voice for a growing movement of undocumented Florida immigrant youth network, known as Students Working for Equal Rights (SWER) to organize communities around education and empowerment. Together with three other DREAMers, Gaby walked over 1,500 miles from Miami, Florida to Washington, D.C., facing the threat of deportation and violence, to bring attention to the cause. She has also advocated for the need for additional scholarship opportunities for exemplary undocumented students. As part of a growing movement of leaders across the nation, Gaby boldly stood up to say that she was undocumented and unafraid, a slogan now commonly used by the undocumented youth community. She is a creative strategist who works with allies in both traditional and nontraditional sectors for greater equality for marginalized communities.

DREAMING IN THE SHADOWS

FRIDAY, OCTOBER 24, 2014

6:00PM - 7:00PM



KEYNOTE SPEAKERS



DR. CAROLA SUÁREZ-OROZCO is a Professor of Education at the Graduate School of Education & Information Studies at the University of California, Los Angeles. Her areas of research include educational achievement among immigrant origin youth, immigrant family separations, the role of mentors in facilitating youth development, the effects of unauthorized status on developing youth, gendered experiences of immigrant youth, the experiences of immigrant origin youth in community college settings as well as civic engagement among emerging adults of immigrant origin. Her books include: Learning a New Land: Immigrant Students in American Society, Children of Immigration,

Transformations: Migration, Family Life, and Achievement Motivation Among Latino Adolescents, and The New Immigration: An Interdisciplinary Reader. Her forthcoming new book is entitled Transitions: The Development of the Children of Immigrants. She has been awarded an American Psychological Association Presidential Citation for her contributions to the understanding of the cultural psychology of immigration and has served as chair of the 2011 APA Presidential Task Force on Immigration appointed by then President Melba Vásquez that produced the report Crossroads: The Psychology of Immigration in the New Century (available at www.apa.org/topics/immigration/report.aspx). She is the editor of the Journal of Adolescent Research and is a senior program associate for the W. T. Grant Foundation.

DEVELOPMENTAL IMPLICATIONS OF UNDOCUMENTED STATUS

SATURDAY, OCTOBER 25, 2014

12:00PM - 1:20PM



**DREAMERS,
IMMIGRATION,
& SOCIAL JUSTICE**
ADVANCING A GLOBAL LATINA/O PSYCHOLOGY AGENDA

CONFERENCE SPONSORS

PADRINOS Y MADRINAS DE LA NLPA

The Chicago School of Professional Psychology
Teachers College, Columbia University
American Psychological Association

AMIG@S DE LA NLPA

Buros Center for Testing
University of Denver, Morgridge College of Education
Society for Personality Assessment
New Mexico State University, Department of Counseling & Educational Psychology

ALIAD@S DE LA NLPA

National Latino Behavioral Health Association
The Gevirtz Graduate School of Education, University of California, Santa Barbara
Latino Psychological Association of New Jersey

KEYNOTE SPEAKER SPONSOR FOR DR. CAROLA SUÁREZ-OROZCO

Division 45 Society for the Psychological Study of Culture,
Ethnicity and Race of the American Psychological Association,



NOCHE DE GALA: AWARDS CEREMONY SPONSOR

Division 17 Society of Counseling Psychology of the American Psychological Association

MEDIA SPONSORS

LatinosinHigherEd.com
University of New Mexico Department of Psychiatry and Behavioral Sciences
Albuquerque Hispano Chamber of Commerce



NLPA'S MISSION

NLPA's mission is to advance psychological education and training, scientific practice and organizational change to enhance the overall well-being of Latina/o populations. NLPA is the professional home for Latina/o psychologists, graduate and undergraduate students, as well as our allies. We are mental health professionals, researchers and educators interested in matters concerning Latina/o psychology.

NLPA LEADERSHIP COUNCIL

Executive Committee (Elected Officers)

Andrés J. Consoli, Ph.D.

President

Marie Miville, Ph.D.

President-Elect

Lynda Field, Ph.D.

Past-President

Lisa M. Edwards, Ph.D.

Secretary

Fred Millán, Ph.D.

Treasurer

Megan Strawsine Carney, Ph.D.

Early Career Representative

Rachel Reinders-Saeman, MA

Student Representative



NLPA LEADERSHIP COUNCIL (CONTINUED)

Appointed Officers

Dianna Marisol González, Ph.D.

Eduardo Morales, Ph.D.

Awards Committee Co-Chairs

Cynthia E. Guzmán, Ph.D.

Conference Chair

Liz Fraga, Ph.D.

Fundraising/Development Chairperson

Héctor L. Torres, Psy.D

International Liaison

& 2014 Presidential Initiative

Azara Santiago-Rivera, Ph.D.

Journal Editor & Senior Advisor

Tiffany Schiffner, Ph.D.

Membership Chairperson

Héctor Y. Adames, Psy.D

Newsletter Editor

Ezequiel Peña, Ph.D.

Professional Development Coordinator

Alison Cerezo, Ph.D.

Regina Jean Van Hell, Ph.D.

Training and Networking Committee Co-Chairs

Brian McNeill, Ph.D.

Psychological Education Issues

Advocate & Historian

Miguel Gallardo, Psy.D.

Psychological Professional Practice

Issues Advocate

Edward Delgado-Romero, Ph.D.

Psychological Science Issues Advocate

& Senior Advisor

Patricia Arredondo, Ed.D.

Senior Advisor

Valerie Minchala, Ph.D.

Student Development Coordinator

Alberta Gloria, Ph.D.

CNPAAEMI LDI Mentor

Brandy Piña-Watson, Ph.D.

CNPAAEMI LDI Fellow 2014-2015

Alison Cerezo, Ph.D.

CNPAAEMI LDI Fellow 2013-2014

Y. Evie Garcia, Ph.D.

CNPAAEMI LDI Representative

APA Council of Representatives Delegate



PRESIDENTIAL CITATIONS

As NLPA 2014 President I would like to recognize three members who have distinguished themselves through their service to our Association. We are a better NLPA because of them.

CYNTHIA E. GUZMÁN, PH.D.

Dr. Cynthia Guzmán has distinguished herself through her service to NLPA as the 2014 Biennial *Conferencia* Chair. Dr. Guzmán devoted herself to this endeavor fully and brought into it matchless passion, creativity, and ingenuity. She secured for us an outstanding venue and attended to every aspect of the conference organization. Moreover, Dr. Guzmán did it all with grace, kindness, and delight. NLPA is better off because of Dr. Guzmán and we are all indebted to her.

HÉCTOR TORRES, PSY.D.

Dr. Héctor Torres, Associate Professor at the Chicago School of Professional Psychology, has distinguished himself by leading the Presidential Initiative for 2014 focusing on understanding Latina/o identities across borders through international engagement. I invite you to read the results of the international survey in the article by Mr. Jared Day, Dr. Torres, and NLPA International Workgroup published in the first edition of *Latina/o Psychology Today* (www.nlpa.ws/newsletters). Please contact Dr. Torres (htorres@thechicagoschool.edu) if you would like to be part of this initiative as advanced by the International Workgroup.

Y. EVIE GARCIA, PH.D.

Dr. Evie Garcia, Associate Professor and Doctoral Training Director of the Counseling Psychology emphasis in Educational Psychology at Northern Arizona University, has distinguished herself for her service to NLPA. Dr. Garcia has served as NLPA's delegate to the American Psychological Association's Council of Representatives. Moreover, Dr. Garcia is a co-founder and board member of the Leadership Development Institute of the Council of National Psychological Associations for the Advancement of Ethnic Minority Interests (CNPAAEMI) representing NLPA. In both capacities, Dr. Garcia's service has been exemplary, all the while providing wise, insightful guidance to NLPA's Leadership Council.

Please join me in expressing our collective appreciation for the outstanding service to NLPA and to our profession provided by them.

iMuchísimas gracias Cynthia, Héctor, & Evie!

ANDRÉS J. CONSOLI, PH.D.
NLPA 2014 President



AWARDS & RECOGNITIONS DESCRIPTIONS

CYNTHIA DE LAS FUENTES DISSERTATION AWARD

The purpose of this award is to support students in finishing their dissertation project. Criteria for the award include: (1) Focusing on issues related to Latina/o Psychology theory, research, or practice; and (2) Contributing in a substantive way to the advancement of knowledge related to Latina/o Psychology. This award includes \$500 through a generous donation by Dra. Cynthia de las Fuentes who is a private practitioner in Austin, Texas.

OUTSTANDING DISSERTATION AWARD

This award recognizes exceptional dissertation research projects that are completed and have been defended since the more recent NLPA conference. The dissertation topic must cover issues related to Latino/a psychology and make a unique contribution to the literature. This award includes \$500 through the generous donation of NLPA Leadership Council members.

DISTINGUISHED STUDENT SERVICE AWARD

This award is conferred upon a graduate student who has made outstanding service contributions to the US Latina/o community. Service contributions can include activities such as the development of creative educational programs or other novel activities in the advancement of service, working to increase funding for agencies, working on legislation regarding mental health, involvement in policy-related issues, and initiating outreach programs. This award includes \$500 through the generous donation of NLPA Leadership Council members.

STAR VEGA DISTINGUISHED SERVICE AWARD

This award is conferred upon a psychologist who has distinguished him or herself through service to the Latino/a community. The award is named in honor and memory of Dr. Star Vega. Dr. Star Vega, Practitioner, Professor of Psychology, and advocate for all psychologists, died Saturday April 24, 2004 at the young age of 55 due to leukemia. Dr. Vega was core faculty in the doctoral program in Clinical Psychology at Phillips Graduate Institute. She was also the 2002 President of the California Psychological Association, the first Latina to occupy this position.



AWARDS & RECOGNITIONS DESCRIPTIONS (CONTINUED)

DISTINGUISHED PROFESSIONAL EARLY CAREER AWARD

This award is conferred upon a psychologist whose contributions have advanced an agenda congruent with NLPA's mission. Early career is defined as 10 years or less since earning a doctoral degree.

DISTINGUISHED PROFESSIONAL CAREER AWARD

This award is conferred upon a psychologist whose contributions have advanced an agenda congruent with NLPA's mission. Distinguished career is defined as 15 years or more since earning a doctoral degree.

DISTINGUISHED PADRINO/MADRINA RECOGNITION

This award is conferred upon a psychologist in recognition of outstanding lifetime achievements congruent with NLPA's mission.



NLPA 2014 AWARDEES

On behalf of the National Latina/o Psychological Association (NLPA) Leadership Council, and NLPA 2014 Awards Committee co-chaired by Drs. Dianna Marisol González and Eduardo Morales, I have the honor to formally announce the recipients of the NLPA 2014 awards and recognitions.

AWARDS

Cynthia de las Fuentes Dissertation Award

Ms. Anahi del Carmen Collado

Outstanding Dissertation Award

Dra. Marlen Kanagui-Muñoz

Distinguished Student Service Award

Ms. Rebecca Rodriguez

Star Vega Distinguished Service Award

Dr. Pierluigi Mancini

Distinguished Professional Early Career Award

Dr. Hector Y. Adames

Distinguished Professional Career Award

Dr. Jose Toro Alfonso

RECOGNITIONS

Distinguished *Madrina* Recognition for Outstanding Lifetime Achievements

Dr. Patricia Arredondo & Dr. Martha Bernal (posthumously)

Distinguished *Padrino* Recognition for Outstanding Lifetime Achievements

Dr. René Díaz-Lefebvre & Dr. Manuel Ramírez III

Please join me in congratulating the recipients of these awards and recognitions. I want to also acknowledge all the applicants for the awards and their nominators for their efforts. The Awards Committee and the Leadership Council had a very challenging task selecting the awardees and recognition recipients as all nominees were most deserving of the awards and recognitions.

I want to thank Drs. González and Morales for their selfless service to NLPA while chairing the Awards Committee. I also thank the jurors who participated in the process: Luz Argelia Gómez, Jeanett Castellanos, Janice Elena Castro, Luz Maria Garcini, Mayra Sanchez, and Lisa Sánchez-Johnsen. Thank you so very much.

Please join me this Saturday at our *Noche de Gala: Awards, Recognitions, Dinner & Dance*. Dr. Cynthia Guzmán, chair of the Conference, and I would like to acknowledge and thank the generous sponsorship of the Noche de Gala provided by the Society of Counseling Psychology (SCP; APA Division 17).

Warmly,

ANDRÉS J. CONSOLI, PH.D.
NLPA 2014 President



MADRINA

DISTINGUISHED *MADRINA* RECOGNITION FOR OUTSTANDING LIFETIME ACHIEVEMENTS



DR. PATRICIA ARREDONDO joined The Chicago School of Professional Psychology as president of the Chicago campus in February 2013. She joined the school after successfully serving in senior administrative roles with the University of Wisconsin-Milwaukee and Arizona State University. Dr. Arredondo is a national leader and scholar on many fronts, extensively published in the areas of multicultural competency development, immigrant issues in counseling, counseling with Latinas/os, women's leadership, and organizational diversity. She has authored more than 100 articles, book chapters, and training videos and is regularly invited for keynote addresses nationally and internationally.

Her most recent book, *Culturally Responsive Counseling for Latinas/os* was published in 2014 by the American Counseling Association (ACA) Press. She considers herself a social justice advocate. Dr. Arredondo served as national president of the American Counseling Association, the largest counseling association in the world, and the only Latina to serve in that role. She was also president of the American Psychological Association Division 45 - Society for the Psychological Study of Ethnic Minority Issues, and the National Latina/o Psychological Association. Dr. Arredondo is the 2013 recipient of the prestigious Henry Tomes Award for Distinguished Lifetime Contributions to the Advancement of Ethnic Minority Psychology, the "Living Legend" award from the ACA, the Lifetime Achievement Award from APA Division 45, an honorary degree from the University of San Diego, and holds Fellow status with the American Psychological Association. She enjoys promoting women's leadership, especially for women of color.



**DREAMERS,
IMMIGRATION,
& SOCIAL JUSTICE**
ADVANCING A GLOBAL LATINA/O PSYCHOLOGY AGENDA

MADRINA

DISTINGUISHED *MADRINA* RECOGNITION FOR OUTSTANDING LIFETIME ACHIEVEMENTS



DR. MARTHA E. BERNAL, PHD was the first woman of Mexican descent to successfully complete her PhD in clinical psychology. She earned her doctoral degree in 1962 at Indiana University. Bernal's graduate experience was marked by a dearth of women and minorities in psychology, which peaked during her postgraduate job search for a faculty position when she received replies from schools that said, "We do not hire women." In 1979, Bernal received a National Research Service Award from NIMH to study how psychologists prepared for work with multicultural populations. She published the results that showed APA-accredited clinical psychology programs had few multicultural curricula for psychologists, and a scarcity of students and faculty of color. That same year, she helped establish the National Hispanic Psychological Association and later served as its second president. In 1986, Bernal became a professor at Arizona State University, where she focused on finding out how Mexican-American children developed their identities and how schools could improve their efforts to provide clinical psychologists with training in minority mental health issues. In 2000, Bernal was recognized for her contributions to Latino psychologists at the Latino Psychology Conference. At APA's 2001 Annual Convention, the Public Interest Directorate awarded Bernal the 2001 Contributions to Psychology Award. Dr. Bernal passed away on September 28, 2001 in Black Canyon City, Arizona. Dr. Bernal was a mentor for many of us, even from afar; she is an authentic pioneer, and is truly worthy of the honor of "Madrina" of the NLPA! (bio contributed by Melba Vasquez).



PADRINO

DISTINGUISHED *PADRINO* RECOGNITION FOR OUTSTANDING LIFETIME ACHIEVEMENTS



DR. MANUEL RAMIREZ III was born in Rio Grande City, Texas on August 15, 1937. He was reared in both Rio Grande and Roma, Texas located in the U.S.-Mexico border region of South Texas. He graduated from Roma High School in 1954 and received a BA in Psychology in 1960 and a Ph.D. in Clinical Psychology from the University of Texas at Austin in 1963. He has taught at California State University at Sacramento, Rice University, Pitzer College of the Claremont Colleges, the University of California at Riverside and the University of California at Santa Cruz. He is currently Professor of Psychology, Director of the Multicultural Processes and Mental Health Lab, and a member of the Clinical Psychology

Training Committee at the University of Texas at Austin. His primary research interests are in the relation of cultural values to mental health and on multicultural processes in personality development and mental health. He developed a course entitled “The Psychology of the Chicano Child” in 1969 and was co-host with Alfredo Castaneda of the first conference on Latina/o Psychology held at the University of California at Riverside in 1973. In the spring of 2014 he completed fifty years of teaching and mentorship in academic environments in California and Texas.



PADRINO

DISTINGUISHED *PADRINO* RECOGNITION FOR OUTSTANDING LIFETIME ACHIEVEMENTS



DR. RENÉ DÍAZ-LEFEBVRE is Professor of Psychology at Glendale Community College, North Campus (Maricopa Community College District), in Glendale, Arizona. During the course of his tenure that spans four decades at six community colleges in California and Arizona, Dr. Díaz has won numerous national and international teaching excellence awards, including being the first Latino to be selected Arizona Professor of the Year. He was selected by the American Association of Hispanics in Higher Education (AAHHE) for the Outstanding Latina/o Faculty Service/Teaching in Higher Education Award and was honored by the Arizona Association of Chicanos for Higher Education

(AACHE) as Professor of the Year. As a founding and lifetime member of NLPA, he has written articles and books in English and Spanish on topics pertinent to community college education, including Howard Gardner's theory on multiple intelligences. Dr. Gardner recognizes him as a "pioneer in applying MI theory at the college and adult levels of learning." Dr. Díaz wrote a chapter, "What If They Learn Differently? Inteligencias Múltiples ¡Despierte el Potencial de Aprendizaje!" in Gardner's book, "Multiple Intelligences Around the World." Dr. Díaz has given faculty in-service workshops and presented papers at numerous colleges and universities nationally and internationally and has been recognized as a leader in the higher education reform movement. Most recently he served as one of two faculty on the American Association of Community College's 21st Century Commission on the Future of Community Colleges, Washington, D.C. Actively serving as the voice for community college faculty, he provided information, research, and resources on meeting the needs of the rapidly growing Latino student population, including DREAMers. Dr. Díaz' biggest satisfaction is mentoring current and former students (including many Latinas/os) who have a passion for psychology. As a veterano, en el movimiento, he attended the first conference on Chicano/Latino Psychology, in 1973, held at UC-Riverside, Califas, Aztlán. "Me siento honrado y humilde de recibir este prestigioso reconocimiento de la NLPA. Pienso en mi familia...mis padres, Alberto y Beatríz, mi abuelita, Doña Cuca, y los que estaban tan influyentes en mi vida y lloré algunas lágrimas."



¡BIENVENID@S!

The National Latina/o Psychological Association welcomes the members of **The Alliance of National Psychological Associations for Racial and Ethnic Equity**

The Alliance is comprised of national psychology organizations committed to the promotion of communication, collaboration, critical consciousness, and strategic actions and projects. The Alliance maintains a commitment toward social justice, racial equity, and cultural diversity. Alliance membership consists of each member organization's President, Immediate Past President or President-Elect plus a standing member of their association's executive board.

THE ALLIANCE PURPOSE

The Alliance serves as a meaningful tool for action, sharing of information and resources, and promotion of an inclusive model of psychology.

- The Alliance meets to address issues of importance to ethnic populations and to the advancement of worldwide psychological interests.
- The Alliance membership operates as learning partners.
- The Alliance, through its meeting structure, provides space for issues to emerge; deliberations to be had; mutually agreed upon priorities to be set; strategies explored, shared, and implemented; resources and access to resources shared.
- The Alliance takes strategic action to pursue “winnable wins” that are mutually beneficial to the associations represented and the constituencies they serve.

THE ALLIANCE ROSTER FOR 2014

American Psychological Association (APA)

Nadine J. Kaslow, Ph.D., ABPP

Jennifer F. Kelly, Ph.D., ABPP

Asian American Psychological Association (AAPA)

Sumie Okazaki, Ph.D.

Kevin Nadal, Ph.D.

Association of Black Psychologists (ABPsi)

Daryl Rowe, Ph.D.

Cheryl Grills, Ph.D.

National Latina/o Psychological Association (NLPA)

Andrés J. Consoli, Ph.D.

Lynda D. Field, Ph.D.

Society of Indian Psychologists (SIP)

Carolyn T. Morris, Ph.D.

Jacque Gray, Ph.D.



**DREAMERS,
IMMIGRATION,
& SOCIAL JUSTICE**
ADVANCING A GLOBAL LATINA/O PSYCHOLOGY AGENDA

¡BIENVENID@S!

The National Latina/o Psychological Association welcomes the members of
CNPAAEMI Leadership Development Institute (CLDI)

NLPA is proud to host the Council of National Psychological Associations for the Advancement of Ethnic Minority Interests (CNPAEMI) Leadership Development Institute (CLDI) fellows training. The CLDI is a yearlong training of six chosen fellows, one from APA's Division 17, one from APA's Division 45, and one from each of the national ethnic minority psychological associations: Asian American Psychological Association (AAPA), Association of Black Psychologists (ABPsi), National Latina/o Psychology Association (NLPA), and Society of Indian Psychologists (SIP). The CLDI is funded by the organizations in CNPAAEMI, as well as Division 17, Division 45, and APA's Commission on Ethnic Minority Recruitment, Retention, and Training in Psychology (CEMRRAT). The CLDI convenes on Thursday October 23, 2014.

FELLOWS

AAPA: Dr. Lou Felipe - University of San Francisco

ABPsi: Dr. Robyn Gobin, Veteran Administration San Diego

Division 17: Dr. Jasmin Llamas, Santa Clara University

Division 45: Dr. David Goode-Cross, Chase Brexton Health Care

NLPA: Dr. Brandy Piña-Watson, Texas Tech University

SIP: Dr. Julii Green, Alliant International University, San Diego

MENTORS

AAPA: Dr. Karen Suyemoto, University of Massachusetts, Boston

ABPsi: Dr. Lisa Whitten, State University of New York, Westbury

Division 17: Dr. Elizabeth Vera, Loyola University Chicago

Division 45: Dr. William Parham, Loyola University

NLPA: Dr. Alberta Gloria, University of Wisconsin, Madison

SIP: Dr. Jacque Gray, University of North Dakota

BOARD MEMBERS

AAPA: Dr. Alvin Alvarez, San Francisco State University

ABPsi: Dr. Ericka Jennifer, Washington, D.C.

Division 17: Dr. Anneliese Singh, University of Georgia

Division 45: Dr. Lisa Rey Thomas, University of Washington

NLPA: Dr. Y. Evie Garcia, Northern Arizona University

SIP: Dr. Wendy Peters, Antioch University Midwest

IMPORTANT INFORMATION ABOUT CONTINUING EDUCATION CREDIT

According to APA policy, in order to obtain a certificate of attendance, participants must:

- 1) Attend the entire workshop or keynote. No partial credit is given for partial attendance.
- 2) Sign-in and sign-out of each workshop or keynote.
- 3) Complete an online evaluation for each workshop or keynote. This will be sent via email within a week of attending the conference. If for some reason you are unable to complete an online evaluation, please see the CE Coordinator.

Once the evaluation has been completed, we will send your certificate via email as a PDF file.

FOR DETAILED INFORMATION REGARDING PROGRAMS OFFERING CE CREDIT, GO TO
[HTTP://NLPACEINFO.WEEBLY.COM/](http://nlpaceinfo.weebly.com/)

Questions?? Contact the Institute for Professional & Continuing Studies at officeofce@thechicagoschool.edu or 312.467.2364



The Institute for Professional & Continuing Studies at The Chicago School of Professional Psychology is approved by the American Psychological Association to sponsor continuing education for psychologists. The Chicago School of Professional Psychology maintains responsibility for this program and its content.



**EDUCATION
INNOVATION
SERVICE
COMMUNITY**



**DREAMERS,
IMMIGRATION,
& SOCIAL JUSTICE**
ADVANCING A GLOBAL LATINA/O PSYCHOLOGY AGENDA

THURSDAY | OCTOBER 23, 2014

NEW MEXICO PSYCHOLOGICAL ASSOCIATION CONFERENCE

PRESENTERS	TITLES	SESSION CODE	CONTENT CODE	TYPE	LOCATION	TIME
	NLPA Leadership Council Retreat	LC		Meeting	Fireplace Room	8:30AM - 5:00PM
	Library of Social Science Exhibit			Vendor	Alvarado A	8:00AM - 5:30PM
	CNPAAEMI LDI Fellows Training Meeting	CLDI		Meeting	Alvarado C	8:00AM - 5:00PM
	Registration				North Atrium	8:30AM - 12:00PM
	NMPA Conference	NMPA		Conference	Alvarado DE	8:00AM - 5:00PM
	Registration				North Atrium	4:30PM - 6:00PM
Andrés J. Consoli, Cynthia E. Guzmán	Students of NLPA Reception			Social	Alvarado B	5:00PM - 6:00PM
	Bienvenida: Welcoming Reception Featuring: Terra Trio			Reception	Franciscan Ballroom	6:00PM - 7:30PM



**DREAMERS,
IMMIGRATION
& SOCIAL JUSTICE**
ADVANCING A GLOBAL LATINA/O PSYCHOLOGY AGENDA

TWEET @1NLPA ABOUT #NLPA2014!



**Successfully Matching
Employers and Job Seekers
in Higher Education**

*Search Our Postings or
Post a Job Today!*

860.632.7676
www.LatinosinHigherEd.com

The #1 Resource for Latina/o Professionals in Higher Education



**DREAMERS,
IMMIGRATION,
& SOCIAL JUSTICE**
ADVANCING A GLOBAL LATINA/O PSYCHOLOGY AGENDA

FRIDAY | OCTOBER 24, 2014

PRESENTERS	TITLES	SESSION CODE	CONTENT CODE	TYPE	LOCATION	TIME
	Registration				North Atrium	7:30AM - 5:30PM
	Breakfast				Alvarado DE	7:30AM - 9:30AM
	Traditional Healers Convocation			Meeting	Juniper Garden	8:00AM - 8:30AM
	Mercado			Exhibits	North/East Atriums	8:00AM - 5:30PM
	Library of Social Science Exhibit			Vendor	Alvarado A	8:00AM - 5:30PM

FRIDAY MORNING: OPENING KEYNOTE PRESENTATION

Andrés J. Consoli, Cynthia E. Guzmán, Isaac Prilleltensky	Welcome & Keynote: Wellness and fairness for all. Bienestar y justicia para todos.	K1	1 CE Credit	Keynote	Alvarado DE	9:00AM - 10:00AM
-----------------------------------------------------------	-----------------------------------------------------------------------------------------------	----	-------------	---------	-------------	------------------

FRIDAY MORNING: PROGRAM SESSION I

Isaac Prilleltensky	Conversatorio with Isaac Prilleltensky	C1		Conversatorio	Fireplace Room	10:00AM - 10:50AM
---------------------	-----------------------------------------------	----	--	---------------	----------------	-------------------



www.personality.org

Join Us March 4-7, 2015
SPA Annual Convention
*Charting the Future of
Personality Assessment*
Marriott New York at
The Brooklyn Bridge

The Society for Personality Assessment is dedicated to the development of methods of personality assessment, the advancement of research on their effectiveness, the exchange of ideas about the theory and practice of assessment and the promotion of the applied practice of personality assessment. With 1500 international members, we are the largest organization in the world with this focus. Our membership is varied and includes clinicians in private practice, forensic assessors, researchers in private and public settings and educators in academic settings.

SPA MEMBER BENEFITS

Six issues of the Journal of Personality Assessment - Reduced rates for the SPA Annual Convention - Two issues of *The Exchange*, the SPA newsletter - Membership to International Society for Rorschach and Projective methods at a reduced fee - Student Grants Available: Diversity, Research & Travel



**DREAMERS,
IMMIGRATION,
& SOCIAL JUSTICE**
ADVANCING A GLOBAL LATINA/O PSYCHOLOGY AGENDA

PRESENTERS	TITLES	SESSION CODE	CONTENT CODE	TYPE	LOCATION	TIME
Vincenzo Teran, Mari Carmen Bennasar	1. Promoting the Personal and Professional Development of Latina/o Bilingual Psychotherapists: Trainee and Faculty Perspectives	R1; 3; 4; 5	Practitioner, Conference Theme & Presidential Initiative	Roundtable Discussions	Franciscan Ballroom	10:00AM - 10:50AM
Lisa Edwards, Carrie Castañeda-Sound, Geneva Reynaga-Abiko	3. Mama y Profesional: Intersecting Roles, Expectations and Opportunities					
Maritza Gallardo-Cooper, Ivelissa Torres-Fernandez, Hector Torres, Edil Torres-Rivera	4. ¿Hablas español?: Language as an agent of social justice advocacy and competent practice with Latinos/as					
Mihaela Dranoff, Ingrid Diaz	5. Living in the Shadows. The Psychological Effects of Living an Undocumented Life in the U.S.					
Andrea Romero, Scott Carvajal, Rebecca Covarrubias	1. Theoretical Advances in the Minority Stress Model for Examining Immigrant Well-being	Theory and Empirical Evidence for Stress and Well-being of Mexican Origin Immigrants S45	Conference Theme & Presidential Initiative; Researcher	Symposium	Alvarado B	10:00AM - 10:50AM
Monica Moreno Anguas, Andrea Romero, Jose Rodas	2. Protective Effects of Neighborhood Cohesion and Familism Against Economic Stress on Hope and Self-esteem of Youth and Parents of Mexican Descent					
Scott Carvajal, Samantha Sabo, Raquel Rubio-Goldsmith, Cecilia Rosales	3. A mixed methods study of social ecological stress and border enforcement mistreatment of Mexican-origin farmworkers in a border community					



**DREAMERS,
IMMIGRATION,
& SOCIAL JUSTICE**
ADVANCING A GLOBAL LATINA/O PSYCHOLOGY AGENDA

PRESENTERS	TITLES	SESSION CODE	CONTENT CODE	TYPE	LOCATION	TIME
Javier Vela, Eunice Lerma, Stacey Gonzalez, Megan Calvillo	1. The Relationship among Individual, Interpersonal, and Institutional Factors on Latina/o High School Students' Mental Health and College Self-Efficacy	The Relationship among Individual, Interpersonal, & Institutional Factors on Latina/o Students' Mental Health and College Self-Efficacy S2	Practitioner; Researcher; Educator	Symposium	Alvarado C	10:00AM - 10:50AM
Javier Vela, Eunice Lerma, Omar Duque, Leticia Cavazos	2. The Relationship among Individual, Interpersonal, and Institutional Factors on Latina/o College Students' Mental Health and Vocational Outcome Expectations	Know Your Latina/o Psychology Roots and Ancestors: The History of Latina/o Psychology S8	Practitioner, Educator	Symposium	Alvarado DE	10:00AM - 10:50AM
Manuel Ramirez	1. The History of Chicana/o Latina/o Psychology	Know Your Latina/o Psychology Roots and Ancestors: The History of Latina/o Psychology S8	Practitioner, Educator	Symposium	Alvarado DE	10:00AM - 10:50AM
Patricia Arredondo	2. The Establishment and Leadership of NLPA	Know Your Latina/o Psychology Roots and Ancestors: The History of Latina/o Psychology S8	Practitioner, Educator	Symposium	Alvarado DE	10:00AM - 10:50AM
Discussants: Brian McNeill, Leticia Arellano-Morales						

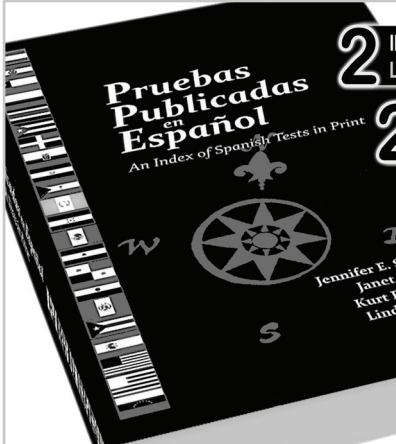

2 IDIOMAS: ESPAÑOL E INGLÉS
LANGUAGES: SPANISH & ENGLISH

2 FORMATOS: IMPRESO Y DIGITAL
FORMATS: PRINT & DIGITAL

422 ENTRADAS DE PRUEBA
TEST ENTRIES

22 CARACTERÍSTICAS DESTACADAS POR PRUEBA
FEATURES HIGHLIGHTED PER TEST

Presenta las descripciones publicadas en español e inglés, una al lado de la otra, en un solo volumen

Convenient format with side-by-side Spanish & English descriptions

El recurso imprescindible sobre pruebas en español

The go-to resource about tests in Spanish

BUROS
CENTER FOR TESTING

sólo/only \$97

Busque nuestro folleto en su bolsa de la conferencia para recibir un cupón de 10% de descuento.
Look for our brochure in your conference bag to receive a 10% discount coupon.

Visit buros.org



**DREAMERS,
IMMIGRATION,
& SOCIAL JUSTICE**
ADVANCING A GLOBAL LATINA/O PSYCHOLOGY AGENDA

PRESENTERS	TITLES	SESSION CODE	CONTENT CODE	TYPE	LOCATION	TIME
Michelle Silva, Manuel Paris, Luis Anez	1. Culturally informed systems change: Lessons learned from a community-academic collaboration	Understanding the Influence of Community and School: Opportunities for Collaboration P8	Researcher; Practitioner	Paper Session	Alvarado F	10:00AM - 10:50AM
Arpana G. Inman, Ohyoung Kwon, Bethany Perkins, William Vogler, & Pegah Eftekharzadeh	2. Addressing Latina/o Mental Health Disparities through School Based Services					
Melissa Morgan Consoli, Kevin Delucio, Emily Unzueta, Kelly Hershman, Erika Noriega	The Santa Barbara Wellness Project: Snapshot of a Formative Evaluation and Curriculum Reconstruction					
William Martinez, Jessica Arizaga, Antonio Polo	4. The Impact of Neighborhood and Individual Cultural Contexts on Internalizing Symptoms in Latino Youth					
Carissa Balderas, Jennifer Merrifield	1. Using Privilege to Advocate for Undocumented Clients in Counseling	Documented Privilege: The role of psychologists in advocating for undocumented community S18	Conference Theme & Presidential Initiative; Practitioner; Advocate	Symposium	Alvarado G	10:00AM - 10:50AM
Cristalís Capielo, Edward Delgado-Romero	2. Using Our Privilege as Documented to Facilitate DREAMERS' Access to Higher Education					
Melanie M. Domenech Rodríguez	3. Documentation Status: Advancing Social Justice at the Macro-level from a position of Privilege					
Discussant: Melba Vasquez						



**DREAMERS,
IMMIGRATION,
& SOCIAL JUSTICE**
ADVANCING A GLOBAL LATINA/O PSYCHOLOGY AGENDA

PRESENTERS	TITLES	SESSION CODE	CONTENT CODE	TYPE	LOCATION	TIME
Eliseo "Cheo" Torres	1. Curanderismo en La Comunidad	Curanderismo En La Comunidad S7	Practitioner	Symposium	Alvarado H	10:00AM - 10:50AM
Brian McNeill	2. Curanderismo and Evidenced Based Psychology Practice					
Melinda García Chair: Brian McNeill	3. Healthy Roots, Healthy Trees: Curanderismo and Clinical Practice					
Jose Navarro	An Existential Liberation Model for working with Gay Latino Men	W1	2 CE Credit Practitioner	Workshop	Potters	10:00AM - 12:00PM
Iris Carrillo	Promoting la Salud Mental of Undocumented College Students: A Call for Action	W2	2 CE Credit; Conference theme & Presidential Initiative; Advocate	Workshop	Weavers	10:00AM - 12:00PM
Melvin Navarro, Susan Kaneshiro, Suliana Lutin	Evidence of Extreme Psychological Hardship in Immigration Evaluations, a Psychologist's Role in Clinical Practice	W11	2 CE Credit Practitioner	Workshop	Turquoise	10:00AM - 12:00PM



FRIDAY MORNING: PROGRAM SESSION II

PRESENTERS	TITLES	SESSION CODE	CONTENT CODE	TYPE	LOCATION	TIME
John Valenzuela	6. Building a Conscious Relationship to my Mexican-American Identity through Depth Psychology	R6, 7, 8, 9, 10	Student; Researcher; Educator	Roundtable Discussions	Franciscan Ballroom	11:00AM - 11:50AM
Eunice Lerma	7. "We can't put abuelita/o in a nursing home." Cultural Expectations of Latino Family Caregivers.					
Ruth Zuniga, Miguel Gallardo, Mari Carmen Bennasar, Shahana Koslofsky	8. Meeting Latinas/os' Individual and Communal Mental Health Needs through Clinical Training Programs					
Melissa Muñoz, Diana Slivensky	9. Sorry, I Don't Speak Spanish: Microaggressions of Non Native Spanish Speaking Latinos					
Cristina Bustos, Milton Fuentes, Alison Cerezo	10. Latina/o Values in Psychology Education & Training					
	NLPA Membership Meeting	M4		Meeting	Fireplace Room	11:00AM - 11:50AM
German Cadenas	1. The Academic Benefits of DREAMers' Advocacy	DREAMers in Higher Education:	Conference Theme & Presidential Initiative; Advocate; Practitioner	Symposium	Alvarado B	11:00AM - 11:50AM
Jesus Cisneros	2. Creating DREAMzones at institutions of higher education and changing education policy	A Holistic Approach to Counseling, Building Allies with DREAM-				
Miguel Arciniega	3. A Holistic Approach to Counseling with Undocumented Students	zone, and Academic Benefits of Students' Advocacy				
		S3				



**DREAMERS,
IMMIGRATION,
& SOCIAL JUSTICE**
ADVANCING A GLOBAL LATINA/O PSYCHOLOGY AGENDA

PRESENTERS	TITLES	SESSION CODE	CONTENT CODE	TYPE	LOCATION	TIME
Shannon Chavez-Korell, Ernesto Noam Lira	1. Differences within Groups: A Quantitative Examination of Campus Climate, Microaggressions, Campus Connectedness, Ethnic Identity and Stress Among College Students of Color	Campus Climate for Latino College Students and Students of Color: United We Survive and Thrive S4	Researcher; Educator; Student	Symposium	Alvarado C	11:00AM - 11:50AM
Rachel Reinders-Saeman, Lester Kern, Luis Altamirano	2. The Power of Narratives: Qualitative Analyses of Campus Climate, Risks, and Resilience as Experienced by College Students of Color					
Marisela López Flores, Angela Lewis	3. New Insights into Ethnic Identity and Campus Climate for Latino College Students and College Students of Color: A Mixed Methods Approach					
Alina Alomá, Esmeralda León, Silvia Salas-Pizaña	4. Translating Campus Climate Research into Action: Implications and Social Justice for Latino College Students and Students of Color					
Sara Buckingham, Lindsay Emery, Jill Scheibler, Mitra Coutier-Delgosha, Anne Brodsky	1. Community Membership, Identity, and Belonging: How Attitudes Towards “Others” Impact the Immigrant Experience	Immigrants & DREAMers I P5	Conference Theme & Presidential Initiative; Researcher; Advocate; Educator	Paper Session	Alvarado F	11:00AM - 11:50AM
2. Marissa Nunes, Claire Okeke, Lisseth Rojas-Flores	2. Hispanic DREAMers Raising Children: Dreams and Realities for the Next Generation					
Elvia Lorena Navarro	3. Luchando por una Educacion: A Qualitative Understanding of Latina/o Undocumented College Student Motivation					
Sally Robles	4. Undocumented Latino Youth Reach for College: Coming of Age in a time of Uncertainty					



**DREAMERS,
IMMIGRATION,
& SOCIAL JUSTICE**
ADVANCING A GLOBAL LATINA/O PSYCHOLOGY AGENDA

PRESENTERS	TITLES	SESSION CODE	CONTENT CODE	TYPE	LOCATION	TIME
Edward Delgado-Romero	1. Culturally Responsive Counseling With Latinas/os: Education and Work	Culturally Responsive Counseling with Latinas/os: Social Justice Implications from the book S6	Practitioner; Educator	Symposium	Alvarado G	11:00AM - 11:50AM
Maritza Gallardo-Cooper	2. Latino/a Centered Counseling: Clinical Practice and Social Justice					
Patricia Arredondo	3. Future Directions in Latina/o Centered Counseling					
Luis Angelo Gomez Riquelme, Berta Rodriguez	1. Chile and the US: A transnational perspective in the training of counselors and psychologists	International perspectives: The training of counselors and psychologists in Chile and the US S9	Conference Theme & Presidential Initiative; Educator	Symposium	Alvarado H	11:00AM - 11:50AM
Faculty from University of Concepción	2. Chile and the US: A transnational approach to the training of counselors and psychologists					
Luis Angelo Gomez Riquelme	3. International perspectives: The training of Chilean counselors and psychologist in Chile and the US					

FRIDAY LUNCH: KEYNOTE PRESENTATION & BOOK SIGNING

Ana Castillo	Lunch & Keynote: For a New Generation of Dreamers	K2	1 CE Credit	Keynote	Alvarado DE	12:00PM - 1:20PM
Ana Castillo	Book Signing with Ana Castillo	BK1		Book Signing	Alvarado A	1:30PM - 2:20PM



FRIDAY AFTERNOON POSTER SESSION

CODE	PRESENTATION TITLE	AUTHOR(S) & AFFILIATION
1	Resilience and Depression in immigrant children separated by the deportation of their parents.	Pilar Maria Gomez-Marmolejo, Pepperdine University; Susy Karraa, Pepperdine University; Mayra Estrada, Student at Pepperdine University; Cesar Rodriguez, Pepperdine University
2	Latina/o Gender Roles: A Literature Review of How Gender Has Been Empirically Studied within the Hispanic Community.	Mark Louie, Teachers College, Columbia University
3	A qualitative analysis of children born in the United States who migrated to Mexico	Elisa DeVargas, University of Oregon; Guillermina Natera, El Instituto Nacional de Psiquiatria; Luis Zayas, University of Texas Austin; M. Andrea Competella, University of Texas Austin; Sergio Aguilar-Gaxiola, University of California Davis
4	Sin Papeles: Latino Parent-Child Conversations about Undocumented Legal Status	Carissa Balderas, University of Georgia; Edward Delgado-Romero, The University of Georgia; Anneliese Singh, University of Georgia
5	The Reunification Project: A group of healing for Latino youth reunited with their parents after an extended absence	Andrea Naranjo, Palo Alto University; Anabel Plasencia, California School of Professional Psychology; Alejandra Diaz, Marin County Mental Health and Substance Use Services
6	Parent Fear of Children's Loss of Language and Familism	Jose Rodas, University of Arizona; Monica Moreno Anguas, The University of Arizona; Andrea Romero, University of Arizona
7	Gender Differences in College Aspirations and Dropout Intentions among Latina/o Students	Jacqueline Fuentes, University of Oregon; Ellen Hawley McWhirter, University of Oregon; Anna McWhirter, University of Oregon
8	Exploring Mental Health Needs of Undocumented Latino/a College Students	Martha Esmeralda Zamudio, Alliant International University/CSPP
9	The Role of Mentorship Undocumented Latina/o Students' Academic Persistence	Maria Isabel Diaz, UC IRVINE; Veronica Franco, Uc Irvine; Jeanett Castellanos, UC IRVINE
10	First-Generation Latino Immigrant Students: Exploring the Relationship between Migration Experience and Education Outcomes	Karina Ramos, University of Oregon; Ellen Hawley McWhirter, University of Oregon
11	After SB 1070: Perceptions of Social Trust and Civic Engagement for Latinas/os In Arizona	Ernesto Reza, Arizona State Hospital



**DREAMERS,
IMMIGRATION,
& SOCIAL JUSTICE**
ADVANCING A GLOBAL LATINA/O PSYCHOLOGY AGENDA

CODE	PRESENTATION TITLE	AUTHOR(S) & AFFILIATION
12	The challenges of Latin American indigenous people in the United States and implications on mental health	Catarina Juan Simon, California School of Professional Psychology- Los Angeles at Alliant International University; Rumiko Okada, PhD, California School of Professional Psychology at Alliant Int. University; Ron Duran, California School of Professional Psychology- Los Angeles at Alliant International University
13	Sin Fronteras: Implications of U.S. Immigration Policies for Latino/a Immigrants	Minnah W. Farook, M.A., University of Kentucky; Silvia P. Salas Pizaña, M.A., University of Wisconsin-Milwaukee, M.A., Hector Y. Adames, Psy.D. & Nayeli Y. Chavez Dueñas Ph.D., The Chicago School of Professional Psychology
14	Acculturation, Parenting Stress, and Children's Internalizing Problems Among Immigrant Latino Families	Anna McWhirter, University of Oregon; Melissa Donovan, University of Oregon
15	Acculturative Stress and the Prevalence of Suicide Behaviors in Latino Youth	Fabiola Audibert, Nova Southeastern University; Lourdes Suarez-Morales, Nova Southeastern University
16	Examining Protective Factors in Latino/a graduate students as determinants of academic achievement.	Pilar Maria Gomez-Marmolejo, Pepperdine University; Susy Karraa, Pepperdine University; Mayra Estrada, Student at Pepperdine University; Cesar Rodriguez, Pepperdine University
17	Guiar un camino: Examining Psychosociocultural Factors within Mentoring Relationships that Influence Latina/os Undergraduates' Educational Journeys	Marla Delgado-Guerrero, University of Wisconsin-Madison
18	Examining the Feasibility of Delivering Behavioral Activation in a Community Setting for Low-income, Spanish-speaking Latinos	Gabriela Nagy, University of Wisconsin-Milwaukee; Maria Santos, University of Wisconsin-Milwaukee; Lino Romero, The Chicago School of Professional Psychology, Washington DC Campus; Azara Santiago Rivera, The Chicago School of Professional Psychology; Jonathan Kanter, University of Washington; Gabriela Diéguez Hurtado, Sixteenth Street Community Health Center, Milwaukee, WI; Paul West, Sixteenth Street Community Health Center, Milwaukee, WI
19	The Role of Religiosity on the Immigrant Health Paradox: Results from the NLAAS	Oswaldo Moreno, Clark University; Esteban Cardemil, Clark University
20	Psicoeducación para Familiares de Personas con Psicosis: Datos Preliminares desde Puerto Rico.	Eliut Rivera-Segarra, Ponce School of Medicine & Health Sciences; Alíxida Ramos-Pibernus, Ponce School of Medicine & Health Sciences



**DREAMERS,
IMMIGRATION,
& SOCIAL JUSTICE**
ADVANCING A GLOBAL LATINA/O PSYCHOLOGY AGENDA

CODE	PRESENTATION TITLE	AUTHOR(S) & AFFILIATION
21	El Estigma hacia Personas que Viven con el Trastorno de Personalidad Límite en Puerto Rico.	Eliut Rivera-Segarra, Ponce School of Medicine & Health Sciences; Alixida Ramos-Pibernus, Ponce School of Medicine & Health Sciences; Domingo Marqués-Reyes, Ponce School of Medicine & Health Sciences
22	Curanderismo Practices Among Mexican-Americans and Its Implications in Clinical Treatment	Eloiza M. Alcaraz, PsyD, Mount St. Mary's College, Los Angeles; CSPP-LA at Alliant International University; Rumiko Okada, PhD, California School of Professional Psychology at Alliant Int. University; Cristina Magalhaes, California School of Professional Psychology at Alliant International University
23	¡Sí Se Puede! Latina Resilience the Face of Oppression	Leticia Arellano-Morales, University of La Verne; Rocio Rosales Meza, University of La Verne
24	“The Development of Psychologists: Professional Social Justice Genogram Serving Latina/os	Matthew Mock, Professor
25	Guatemalan Children's Cultural and Developmental Perspectives of Disability	Nancy Herrera, University of Wisconsin-Madison; Steve Quintana, Professor, UW-Madison; Stephanie D'Costa, UW-Madison Student; Jocelyn Kuhn, UW-Madison Student; Mayra Rodriguez, UW-Madison Student; Rod Salgado, UW-Madison Student; Lauren Wuchte, UW-Madison Student
26	Family Obligation and Gender as Moderators of the Stress-Depression Relationship among Low Income Latino Youth	Melek Yildiz Spinel, DePaul University; Danielle Adams, Roosevelt University; Antonio Polo, DePaul University
27	Factors Influencing Latinas/os' Professional Help-Seeking Attitudes and Intentions	Rachel Navarro, University of North Dakota; Ricardo Torres, New Mexico State University; Diana Slivensky, University of North Dakota; Stephanie Bono, University of North Dakota; Lindsey DeVries, University of North Dakota
28	The acculturation experience of the Latino/a therapist and its impact on working with clients from the same ethnic group	Luis Antonio Becerra, California School of Professional Psychology at Alliant Int. University; Rumiko Okada, PhD, California School of Professional Psychology at Alliant Int. University; Krystal Edmonds-Biglow, Psy.D., California School of Professional Psychology at Alliant Int. University



FRIDAY AFTERNOON: PROGRAM SESSION III

PRESENTERS	TITLES	SESSION CODE	CONTENT CODE	TYPE	LOCATION	TIME
Ivelisse Torres-Fernandez, Anna Lopez, Anna Laura James, Carolina Sandoval	11. Bilingual Supervision: Challenges, Opportunities, and Future Directions	R11; 12; 13; 16	Practitioner, Conference Theme & Presidential Initiative	Roundtable Discussions	Franciscan Ballroom	2:30PM - 3:20 PM
Gabriela Nunez, Gabriela Lopez	12. Undocumented “Patients” in a Medical-Setting: Inadherence to Treatment or “La Migra Fear?”					
Yuliana Diaz, Olga Amador, Manijeh Badiee	13. Identity disconnect with the Latino heritage from generation to generation					
Elvia Lorena Navarro, Luz Garcini, Angela Guterrez, William Martinez, Manuel Salgado Jr.	16. What we know & what we need to know about the health of undocumented Latino immigrants in the United States: Developing a Research Agenda.					
	SIG Meeting: Orgullo	M2		Meeting	Fireplace Room	2:30PM - 3:20 PM



**DREAMERS,
IMMIGRATION,
& SOCIAL JUSTICE**
ADVANCING A GLOBAL LATINA/O PSYCHOLOGY AGENDA

PRESENTERS	TITLES	SESSION CODE	CONTENT CODE	TYPE	LOCATION	TIME
Rachel Stein	1. Towards a Continued Understanding of Homework Challenges for Bicultural and Bilingual Families	Adolescents & Children P2	Practitioner; Educator	Paper Session	Alvarado B	2:30PM - 3:20 PM
Monique Jiménez	2. Improving the quality of life of Latino/Hispanic gay, lesbian, bisexual, transgender and questioning (LGBTQ) adolescents and their families					
Michael Paz	3. The Meaning of Language and Culture for Second Generation, Bilingual, Mexican American, 5th Grade Students					
Carla Camacho	4. Academically Successful Latino Youth: Contextual, Familial, and Resilience Dynamics					
Kevin Delucio, Melissa Morgan Consoli, Lucas Torres	1. Using a Mixed Methods Design	Using a Mixed Methods Design to Explore Discrimination and Thriving in Latino/as S10	Researcher	Symposium	Alvarado C	2:30PM - 3:20 PM
Natasha Najjar, Lucas Torres	2. A Quantitative Examination of Ethnic Microaggressions and Thriving					
Melissa Morgan-Consoli, Emily Unzueta, Kelly Hershman, Frances Alfonzo, Claire Bird, Kevin Delucio, Natasha Najjar, Lucas Torres	3. Exploring Thriving and Discrimination Through a Qualitative Approach					

Chairs: Lucas Torres & Melissa Morgan Consoli
Discussant: Lisa Edwards



**DREAMERS,
IMMIGRATION,
& SOCIAL JUSTICE**
ADVANCING A GLOBAL LATINA/O PSYCHOLOGY AGENDA

PRESENTERS	TITLES	SESSION CODE	CONTENT CODE	TYPE	LOCATION	TIME
Patricia Arredondo Melba Vasquez Discussant: Azara Santiago Rivera Chair: Marie Miville	1. Latina Leaders and our Multiple Identities and Capabilities 2. Latina/o Leadership: Empowering Future Leaders	Latina/o Leadership in Action S1	ECP; Advocate	Symposium	Alvarado DE	2:30PM - 3:20 PM
Marisela López Flores	1. Multicultural competencies in working with Latina/os: Moving the field from awareness and knowledge to skills	Cultural Competence & Training Issues P4	Practitioner	Paper Session	Alvarado F	2:30PM - 3:20 PM
Nadia Thalji	2. "The Other Chair: Exploring the experience of non-native therapists treating native-born patients in the USA"					
Martin La Roche	3. Psychotherapeutic and Assessment Implications of the DSM-5 for Latinos					
Melissa Alvarado, Eunice Lerma	4. Challenges Faced by Spanish Speaking Student Counselors: A Call for Action					



Pamelya P. Herndon
Executive Director

1410 Coal Avenue SW
Albuquerque, New Mexico 87104
505.244.0502 | Fax 505.244.0506 | Mobile 505.385.4518
pherndon@swwomenslaw.org | www.swwomenslaw.org

Estimados Colegas: una invitación para Uds.

Please visit, follow and disseminate my blog:

<http://healing-the-immigrant-family.com>

From: Silvia Araneda Burwell, LPC



**DREAMERS,
IMMIGRATION,
& SOCIAL JUSTICE**
ADVANCING A GLOBAL LATINA/O PSYCHOLOGY AGENDA

PRESENTERS	TITLES	SESSION CODE	CONTENT CODE	TYPE	LOCATION	TIME
Araceli Gonzalez, Audra Langley, John Piacentini	1. Anxiety and Treatment Outcomes in Latino and Non-Hispanic White Youths: Results from a Large Efficacy Trial	Anxiety Interventions for Latino Youths Across Diverse Settings S15	Researcher; Practitioner	Symposium	Alvarado G	2:30PM - 3:20 PM
Lindsay Holly, Julia Humphrey, Henry Wynne, Amanda Chiapa, Ryan Stoll, Armando Pina	2. School-based Indicated Prevention for Childhood Anxiety: A Randomized Trial with Caucasian and Hispanic/Latino Children					
Cristina Bustos, Denise Chavira	3. Adapting Evidence-Based Practices for Rural Latino Children with Anxiety					
Denise Chavira, Cristina Bustos, Bernardo Ng, Alvaro Camacho	4. Improving Care for Rural Latino Children with Anxiety: Feasibility Outcomes from a Pilot RCT					
Discussant: Steven Lopez Chair: Araceli Gonzalez						
Rafael Hernandez	1. Promoting Latina/o Mental Health and College Persistence: Effective Coping Responses to Racial Microaggressions	Latina/o Resilience and Well-being: Coping with Acculturative Stress and Racial Microaggressions-From Theory to Practice S16	Practitioner; Educator	Symposium	Alvarado H	2:30PM - 3:20 PM
Sara Castro-Olivo	2. F.U.E.R.S.A.S.: A Culturally Responsive Social-Emotional Resiliency Building Intervention for Latina/o Immigrant Families					
Darren Bernal	3. Social Status and Well-Being in Latina/o Immigrants: Does Status Matter?					



**DREAMERS,
IMMIGRATION,
& SOCIAL JUSTICE**
ADVANCING A GLOBAL LATINA/O PSYCHOLOGY AGENDA

PRESENTERS	TITLES	SESSION CODE	CONTENT CODE	TYPE	LOCATION	TIME
Miguel Gallardo, Melanie M. Domenech Rodríguez, Lynda Field, Cristalís Capielo	El trabajo compartido es mas llevadero: Creating a Latina/o Culturally Affirming Ethics Code	W10	3 CE Credit Practitioner; Advocate	Workshop	Potters	2:30PM - 5:30 PM
Tom Chavez, Tonita Gonzales, Eliseo "Cheo" Torres, Rita Navarrete	Historical and Contemporary Practices of Curanderismo: Addressing the Holistic Needs of New Mexican Communities	W4	3 CE Credit Practitioner	Workshop	Weavers	2:30PM - 5:30 PM
Andrea Iglesias, Glenda Russell	The Implicit Attitudes Model as an Avenue for Social Justice	W7	3 CE Credit Practitioner; Advocate	Workshop	Turquoise	2:30PM - 5:30 PM

IDEAL FOR PARENT RECOMMENDATION FROM GUILFORD

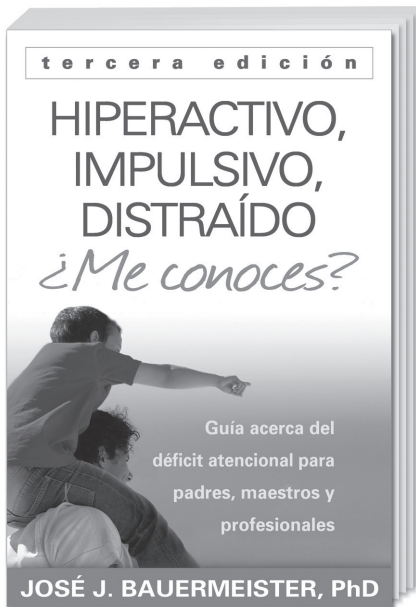

2014, 6" x 9" Paperback, 323 Pages
ISBN 978-1-4625-1236-2, \$16.95

"Written for Hispanic parents—but equally useful for professionals—this book describes in detail what ADHD is and how it affects children of different ages... Dr. Bauermeister helps us face the challenges of ADHD and deal with our own emotional reactions in tough situations. A 'must read.'" —**Héctor R. Bird, MD**

Hyperactive, Impulsive, Distracted, Do You Know Me?, THIRD EDITION

A Guide on Attention Deficit for Parents, Teachers, and Professionals

José J. Bauermeister, PhD

Foreword by **Russell A. Barkley, PhD, ABPP, ABCN**

Written expressly for Spanish-speaking families—and the teachers and other professionals who work with them—this book provides essential guidance from a leading expert on ADD and ADHD. José J. Bauermeister presents sound scientific knowledge on the nature of attention problems and why children with these disorders act the way they do. Parents get tips and techniques for overcoming behavior problems, and, if needed, finding the right professional help. The experiences and culture of Hispanic children and families are reflected on every page. Written in Spanish (not a translation).

**Stop by the Library of Social Science tables
in the Alvarado A Room to order your copy now!**



FRIDAY AFTERNOON BREAK ~ 3:20PM - 3:40PM

FRIDAY AFTERNOON: PROGRAM SESSION IV

PRESENTERS	TITLES	SESSION CODE	CONTENT CODE	TYPE	LOCATION	TIME
Jose Navarro, Crystal Martinez, Eva Torres, Manijeh Badiee	15. "Ni de Aqui, Ni de Alla" - A Latina Woman's Quandary on Ethnic Identity	R15; 18; 19; 20	Educator; Conference Theme & Presidential Initiative	Roundtable Discussions	Franciscan Ballroom	3:40PM - 4:30PM
Jacqueline Coppock, Bernadette Solorzano, Sylvia Rapini De Yatim	18. La Procecion Va Pa Dentro					
Oscar Rojas Perez, Nancy Herrera	19. El Valor de la Confianza: Developing Relationships with Latin@ Immigrant/ Undocumented Communities and Researchers					
Andrés J. Consoli, Jose Toro-Alfonso, Hector Torres, Carlos Zalaquett	20. Interamerican Society of Psychology and NLPA: Advancing international engagement across the Americas					
	Latina Researchers Network Meeting	M3		Meeting	Fireplace Room	3:40PM - 4:30PM



PRESENTERS	TITLES	SESSION CODE	CONTENT CODE	TYPE	LOCATION	TIME
Lisa Sánchez-Johnsen, Liliana Bolanos, Regina Reina, Eduardo Bastian, Jaime Delgado, Jose Luis Rodriguez, Hui Xie, Enrique Elli, Julia Escamilla, Marian Fitzgibbon, Daniel LeGrange	1. Body Image, Physical Activity, and Cultural Variables in Puerto Rican and Mexican Women	Interventions II P12	Practitioner; Researcher	Paper Sessions	Alvarado B	3:40PM - 4:30PM
Cristina del Busto, Yasmin Rey, Jeremy Pettit, Wendy Silverman	2. Child and Parent Ratings of Anxiety in First and Second Generation Latino Children with with Selective Mutism or Social Anxiety Disorder					
Maria Santos, Gabriela Nagy, Lino Romero, Azara Santiago Rivera, Jonathan Kanter, Gabriela Diéguez Hurtado, Paul West	3. RCT of Behavioral Activation for Latinos with depression: A model for community-based participatory research					
Alejandrina Estrada	4. Daring To Embrace The Spiritual: Spiritual/Religious Interventions with Latinas in a Cancer Support Group					

Congratulations

National Latina/o Psychological Association
on your **2014 Biennial Conference!**



ABRAZO
MULTICULTURAL
MARKETING + COMMUNICATION

www.abrazomarketing.com



**DREAMERS,
IMMIGRATION,
& SOCIAL JUSTICE**
ADVANCING A GLOBAL LATINA/O PSYCHOLOGY AGENDA

PRESENTERS	TITLES	SESSION CODE	CONTENT CODE	TYPE	LOCATION	TIME
Brandy Piña-Watson	1. Influence of the caregiver-child acculturation gap on Mexican American adolescent depression and suicidality	Developing a Greater Understanding of Cultural Impacts on Depression and Suicidality for Mexican American Adolescents S11	Researcher	Symposium	Alvarado C	3:40PM - 4:30PM
Marianela Dornhecker, Brandy Piña-Watson, Samantha Salinas	2. The role of gender and bicultural stressors on Mexican American adolescents' depressive symptoms and suicidality					
Brandy Piña-Watson , Ana Abraído-Lanza	3. "Is it God or Luck?": Fatalismo and Mexican American Adolescents' Mental Health					
Chair: Brandy Piña-Watson Discussant: Andrea Romero						
Isaac Prilleltensky, Yolanda Flores Niemann	Interested in becoming a full professor or a senior leader in higher education? Guidelines and recommendations for Latin@ psychologists and their allies	W5	2 CE Credit ECP	Workshop	Alvarado DE	3:40PM - 5:40PM



**DREAMERS,
IMMIGRATION,
& SOCIAL JUSTICE**
ADVANCING A GLOBAL LATINA/O PSYCHOLOGY AGENDA

PRESENTERS	TITLES	SESSION CODE	CONTENT CODE	TYPE	LOCATION	TIME
Luz Garcini, Angela Gutierrez, Monica Ulibarri, Elizabeth Klonoff	1. "Cosa de Locos:" Myths, Beliefs, and Mental Health Needs of Undocumented Latino Immigrants in San Diego County	Immigrants & DREAMers II P6	Conference Theme & Presidential Initiative; Practitioner; Researcher	Paper Sessions	Alvarado F	3:40PM - 4:30PM
Maria Gurrola, Cecilia Ayon	2. Mexican adolescents' education "Hopes in an anti-immigrant environment: Perspectives of first/ second-generation youth and parents"					
Carmen Roman	3. Stress Coping and Resilience in Undocumented Mexican Immigrants: The Role of Traditional Mexican Art					
Alison Cerezo, Allan Avila- Espina, Claudia Padilla	4. Understanding the Mental Health Needs of Latina Queer Immigrants					
Helena Aredo	5. Sociopolitical and counseling needs of undocumented Salvadoran immigrants					
Jose Cervantes	1. Empowering Undocumented Latina/o University Students Towards Wellness	Resiliency and Strength- Based Inter- ventions with Undocument- ed Latina/o University Students S14	Advocate; Conference Theme & Presidential Initiative	Symposium	Alvarado G	3:40PM - 4:30PM
Laura P. Minero Discussant: Luis Vargas	2. Fostering Resiliency Among Undocumented Students as Latino Mental Health Practitioners, Faculty, and Staff					



PRESENTERS	TITLES	SESSION CODE	CONTENT CODE	TYPE	LOCATION	TIME
Miguel Vázquez Rivera	1. Attitudes about and Knowledge of Lesbians and Gays: Psychologists and Psychology Students in Mexico-City	Working with Latino/Hispanic LGBT clients: Psychologists attitudes, LGBT psychological issues and culturally appropriate treatments S5	Student; Researcher; Practitioner	Symposium	Alvarado H	3:40PM - 4:30PM
Jason Platt	2. The Experiences of the LGBT Latino/Hispanic Community: How Culture, Religion, and Gender Intersect					
Monique Jiménez	3. Providing Culturally Appropriate Services to Latino/Hispanic Lesbian, Gay, Bisexual and Transgender (LGBT) Clients					

FRIDAY AFTERNOON: PROGRAM SESSION V

PRESENTERS	TITLES	SESSION CODE	CONTENT CODE	TYPE	LOCATION	TIME
Dianna M. González, E. Lorena Navarro	Bilingual Issues in Latina/o Mental Health SIG	M7		Meeting	Fireplace Room	4:40PM - 5:30PM
Cristina Bustos, Josephine Serrata, Benedict McWhirter	1. Safety Planning for Latinas Experiencing Violence: Considering the Intersections	Interpersonal Violence P3	Researcher Practitioner	Paper Session	Alvarado B	4:40PM - 5:30PM
Flor de María Gamboa, Martin Alcalá Ochoa	2. Feminine/ discriminated/excluded: a conceptual metonymy in order to understand male violence against women.					
Blanca Caro	3. Assessing Risk for Intimate Partner Homicide in Latinas					
Danielle Quintero, Alejandro Morales	4. Examining the Impacts of Sexual and Domestic Violence on Sexual Minority Latinas					



**DREAMERS,
IMMIGRATION,
& SOCIAL JUSTICE**
ADVANCING A GLOBAL LATINA/O PSYCHOLOGY AGENDA

PRESENTERS	TITLES	SESSION CODE	CONTENT CODE	TYPE	LOCATION	TIME
Jeanette Santos, Martha Guerra	21. Enhancing the therapeutic experience for Latina/o Immigrants by using the Reflecting Team Model and Positive Psychology Interventions	R21, 22, 24, 25, 35	Practitioner; Researcher; ECP	Roundtable Discussions	Franciscan Ballroom	3:40PM - 4:30PM
Brenda Padilla, Jesus Perez, Diana Mendez	22. Supporting the Development of Latino/a Psychologists: Reflections from Faculty, Training Programs, Supervisors, and Students					
Elizabeth Fraga, Mariel Buque, Luisa Bonifacio	24. Talking like a 6th grader: Counselor challenges and barriers to providing mental health services in Spanish					
Natalia Holik	25. Surviving Slavery: Addressing the Psychological Needs of Human Trafficking Survivors					
Azara Santiago- Rivera, Consuelo Arbona, Esteban Cardemil, Edward Delgado-Romero, Andrea Romero	35. Journal of Latina/o Psychology: Editors' Roundtable					
Hector Torres, Andrés Consoli, Gregory Benson- Flórez	1. The Internalization of Psychology and Improving the Lines of Communication with Latin America	The Inter- nalization of Psychology: Its Impact on Latino/a Men- tal Health and Our Role S12	Conference theme & presidential initiative	Symposium	Alvarado C	3:40PM - 4:30PM
Claudette "Claudia" Antuña	2. The Use of Internationally Normed Assessment with Latino/a Populations					
Alexis Miranda, Ruth Zuniga	3. Ethical Imperatives Inherent in the Internationalization of Psychology: Clinical, Research, and Other Considerations					



**DREAMERS,
IMMIGRATION,
& SOCIAL JUSTICE**
ADVANCING A GLOBAL LATINA/O PSYCHOLOGY AGENDA

PRESENTERS	TITLES	SESSION CODE	CONTENT CODE	TYPE	LOCATION	TIME
Fernando Estrada, Miguel Arciniega	1. Positive masculinity as a predictor of familismo and support seeking among Latino men	Gender P7	Researcher; Practitioner	Paper Session	Alvarado F	4:40PM - 5:30PM
Gena Castro Rodriguez	2. Pathways and Relationships Between Sexual Trauma and Juvenile Delinquency for African and Latina Girls					
Delida Sanchez	3. Exploring Marianismo and Its Relation To Depression and Sexual Risk Behaviors In Latina Adolescent Girls					
Amanda Arévalo Lapin, Carlos Arturo Clavijo Meneses, Miriam Camacho Valladares, Sotero Moreno Camacho, Daniela Barrios Rodríguez, Miriam Almeida Quintero	4. Relationship between values and resilience In mexican women: a cross-sectional study					
Eduardo Estevis, David Gonzalez	1. Neuropsychological Assessment of Spanish-Speakers	Neuropsychological Assessments and the Latina/o Client S21	Practitioner; Student; Educator	Symposium	Alvarado G	4:40PM - 5:30PM
David Gonzalez	2. Neuropsychological Assessment in Latina/os: Review of Research and Future Directions					
Rut Gubkin, Jorge Wong	Latino/as leadership—An agenda for social justice	Latino/as leadership—An agenda for social justice S20	Advocate; ECP	Symposium	Alvarado H	4:40PM - 5:30PM



**DREAMERS,
IMMIGRATION,
& SOCIAL JUSTICE**
ADVANCING A GLOBAL LATINA/O PSYCHOLOGY AGENDA

FRIDAY EVENING: WEDREAM CULTURAL EVENT

PRESENTERS	TITLES	SESSION CODE	CONTENT CODE	TYPE	LOCATION	TIME
Andrés J. Consoli, Cynthia E. Guzmán, Gaby Pacheco	WeDREAM: DREAMing in the Shadows. Keynote Speaker: Gaby Pacheco, DREAMer and Activist			Reception	Juniper Garden	6:00PM - 7:00 PM
Students of NLPA	Social Gathering			Social	Garduños	7:30PM - 9:30 PM
ECPs of NLPA	Social Gathering			Social	Meet in Lobby	7:30PM - 9:30 PM

APA SUPPORTS...

...the **NATIONAL LATINA/O PSYCHOLOGICAL ASSOCIATION** in its **2014 BIENNIAL CONFERENCE**,

Dreamers, Immigration & Social Justice: Advancing a Global Latina/o Psychological Agenda



The **AMERICAN PSYCHOLOGICAL ASSOCIATION (www.apa.org)**, in Washington, DC, is the largest scientific and professional organization representing psychology in the United States. APA's membership includes nearly 130,000 researchers, educators, clinicians, consultants and students.

Through its divisions in 54 subfields of psychology and affiliations with 60 state, territorial and Canadian provincial associations, APA works to advance the creation, communication and application of psychological knowledge to benefit society and improve people's lives.



SATURDAY | OCTOBER 25, 2014

PRESENTERS	TITLES	SESSION CODE	CONTENT CODE	TYPE	LOCATION	TIME
	Registration				North Atrium	7:30AM - 5:30PM
	Breakfast				Alvarado DE	8:00AM - 10:00AM
	Mercado			Exhibits	North/East Atriums	8:00AM - 5:00PM
	Library of Social Science Exhibit			Vendor	Alvarado A	8:00AM - 4:00PM

SATURDAY MORNING: PROGRAM SESSION I

PRESENTERS	TITLES	SESSION CODE	CONTENT CODE	TYPE	LOCATION	TIME
Karina Ramos	1. Advice from a current intern on how to prepare for internship interviews, ranking, and match day	Predoctoral Psychology Internships: Preparing, Applying, & Interviewing S13	Student	Symposium	Alvarado B	9:00AM - 9:50AM
Marla Delgado-Guerrero	2. Predoctoral Application Preparation: Recommendations to Set Yourself Apart from the Pack					
Lynda D. Field	3. Advice from a Training Director on how to get the internship you want and how to be prepared					
Virginia Longoria Eve Adams	Contemplating culture: Mindfulness interventions applied to oppression-based suffering	W16	2 CE Credit; Practitioner; Advocate	Workshop	Alvarado DE	9:00AM - 11:00AM



**DREAMERS,
IMMIGRATION,
& SOCIAL JUSTICE**
ADVANCING A GLOBAL LATINA/O PSYCHOLOGY AGENDA

PRESENTERS	TITLES	SESSION CODE	CONTENT CODE	TYPE	LOCATION	TIME
Jorge Marquez	1. La vida en la frontera: Understanding the impact of border culture on the mental and emotional well-being of Latino college students in El Paso, Texas	Examining the Clinical Needs of Latina/o College Students along the U.S./Mexico Border at Hispanic-Serving Institutions S38	Practitioner Conference Theme & Presidential Initiative	Symposium	Alvarado C	9:00AM - 9:50AM
Carol Fonseca	2. Beyond borders: Examining the psychological needs and clinical efforts at New Mexico State University					
Maria Arizaga	3. Alternative ways of healing: Exploring how curanderismo can supplement therapy with Latino college students					
Ignacio David Acevedo-Polakovich, Ana Baumann, Melanie M. Domenech Rodríguez, Larissa Niec	1. Getting familias to the Table: Framing Latina/o service disparities in parenting-interventions	Welcoming Familias to the Table: Getting Parenting Interventions to U.S. Latina/o families in Need S43	Practitioner; Researcher	Symposium	Alvarado F	9:00AM - 9:50AM
Melanie M. Domenech Rodríguez	2. Como se dice "parenting"? The cultural adaptation of parenting interventions					
Ana Baumann	3. Parent interventions in usual care: Where are they?					
Larissa Niec, Ignacio David Acevedo-Polakovich	4. Partnering with Latina/o Communities to Develop Sustainable Parenting Interventions					



**DREAMERS,
IMMIGRATION,
& SOCIAL JUSTICE**
ADVANCING A GLOBAL LATINA/O PSYCHOLOGY AGENDA

PRESENTERS	TITLES	SESSION CODE	CONTENT CODE	TYPE	LOCATION	TIME
Olga Amador, Anahi Angel, Manijeh Badiie	1. Empowerment Process of Latina/Hispanic Women and Their Impact on the Community	Latina/ Hispanic Women: Strengths and Best Practices in the Community S34	Practitioner; Researcher; Advocate	Symposium	Alvarado G	9:00AM - 9:50AM
Evelyn Ayala, Yuliana Diaz, Manijeh Badiie	2. Latino Research Experiences and Best Practice					
Eloiza M. Alcaraz	Curanderismo and Latino Culture-Specific Syndromes: Working Towards Greater Cultural Competence	W13	2 CE Credit Practitioner; Educator	Workshop	Alvarado H	9:00AM - 11:00AM
Lydia Buki	1. Publishing from the Editor's Perspective	The Nuts and Bolts of the Publication Process S35	ECP; Researcher; Student	Symposium	Potters	9:00AM - 9:50AM
Loreto Prieto, Lydia Buki	2. Successful Publishing Strategies					
Chair: Lydia Buki						
Natalia Holik	1. The Imperative Narrative: Deconstructing the Dominant Discourse of the Hospital Patient	Treating Illness vs. Promoting Well-being: Incorporating Strengths-Based Therapies in a Hospital Setting S36	Practitioner	Symposium	Weavers	9:00AM - 9:50AM
Amanda Wetegrove-Romine	2. Addressing Illness and Amplifying Solutions: Promoting the Strengths of the Latino Patient					



PRESENTERS	TITLES	SESSION CODE	CONTENT CODE	TYPE	LOCATION	TIME
Yajaira Johnson-Esparza, Patricia Rodriguez Espinsa, Natalia Moss, Gabriela Lopez, Rebecca Rieger, Jennifer Benson, Kamilla Venner, Steven Verney	1. Development of a Diversity Clinic in Graduate Training in Collaboration with a Community Mental Health Center: Framework for Enhancing Diversity Training	Beyond Basic Cultural Diversity Requirements: Entrenamientos Culturalmente Adecuados para Nuestras Comunidades S37	Educator; Practitioner	Symposium	Turquoise	9:00AM - 9:50AM
William Wagner	2. Vía a La Salud: Creating a Behavioral Health Care Pipeline in New Mexico					
Xochitl Campos Biggs, Ivette Miramontes, Edith Garcia	3. Nunca Es Tarde Para Aprender Aunque Seas Profesional: Increasing Competence to Address Mental Health Dilemmas for Underserved Communities					
Chair: Kee J.E. Straits						

SATURDAY MORNING: PROGRAM SESSION II

PRESENTERS	TITLES	SESSION CODE	CONTENT CODE	TYPE	LOCATION	TIME
Gabriela Lopez	1. Posttraumatic growth in unaccompanied undocumented minors from Central American Countries	Positive Psychology in Practice: migration journeys, U.S. school attendance, and healthcare services of undocumented children S26	Practitioner; Conference Theme & Presidential Initiative	Symposium	Alvarado B	10:00AM - 10:50AM
Sylvia Rapini De Yatim	2. Professional counselors serving Hispanic undocumented students in the U.S					
Wade Petree	3. Integrating Curanderismo and Positive Psychology: Enhancing Latino Immigrants Health Care Experience in Child Chronic Illness					



**DREAMERS,
IMMIGRATION,
& SOCIAL JUSTICE**
ADVANCING A GLOBAL LATINA/O PSYCHOLOGY AGENDA

PRESENTERS	TITLES	SESSION CODE	CONTENT CODE	TYPE	LOCATION	TIME
Daryl Rowe, Linda James Myers	17. Creating Just Spanish- African and Portuguese- African Cultural and Psychological Spaces	R17; 26-30; S26	Conference Theme & Presidential Initiative, Researcher; Student	Roundtable Discussions	Franciscan Ballroom	10:00AM - 10:50AM
Lydia Buki, Azara Santiago Rivera, Michael Zarate	26. Editors Roundtable: CDEMP, JLP, TCP					
Karina Ramos, Citlaly Gonzalez, German Cardenas	27. The Path Less Traveled: Former Undocumented Immigrants' Tips for Navigating Higher Education for Undocumented Youth					
Alejandrina Estrada, Monica Hurtado-Leon, Daniel Silva, Nicolasa Munoz	28. The Mentoring Relationship: Latina/o Doctoral Students and Faculty Share Their Experience of Mentorship					
Carrie Castaneda- Sound, Miguel Gallardo, Patricia Arredondo	29. Meaning and Purpose in the Lives of Latina/o Psychologists: What Sustains Us?					
Martha Guerra, Jeanette Santos, Nidia Varela	30. Implementing a strength-based approach when working with Unaccompanied Alien Children (UAC) who are placed in the custody of Office of Refugee Resettlement (ORR)					



**DREAMERS,
IMMIGRATION,
& SOCIAL JUSTICE**
ADVANCING A GLOBAL LATINA/O PSYCHOLOGY AGENDA

PRESENTERS	TITLES	SESSION CODE	CONTENT CODE	TYPE	LOCATION	TIME
Carlos Rivera Villegas, Marie-Christine André, Sarah Shea, Lisa Coyne	1. The Role of Depression, Emotion Regulation, Acceptance, and Stress in Latina Mothers	Expression and Perception of Depression among Latina Women and their Children S22	Student; Researcher	Symposium	Alvarado C	10:00AM - 10:50AM
Marie-Christine André, Jadig Garcia, Angela Currie, Lisa Coyne	2. The Role of Emotion Regulation, Expression, and Depressive symptoms on Latina Mothers' Perceptions of Their Children's Behaviors					
Jadig Garcia, Debra Harkins Discussant: Lynda Field	3. The Impact of Cultural Involvement on the Understanding of Latina's Depressive Symptoms					
Jorge Marquez	1. Latino Caregivers' Reasons for Seeking Treatment for Relatives with Serious and Persistent Mental Illness	Discrimination and Help-seeking P10	Researcher; Practitioner	Paper Session	Alvarado F	10:00AM - 10:50AM
Verónica Rabelo	2. Invisibility as a Form of Workplace Discrimination: A Mixed-Methods Study of a Diverse Custodial Workforce					
Esteban Cardemil, Oswaldo Moreno, Monica Sanchez, Tamara Nelson, Kristen Keefe, Rachel Ishikawa	3. Latino men and depression: A culture- and gender-based model of help-seeking behavior					
Irene Lopez, Erin Rodriguez, Rafael Ramirez, Glorisa Canino, Hector Bird	4. Neither Here Nor There: Boundary Violations in the Study of Ataques de Nervios					



**DREAMERS,
IMMIGRATION,
& SOCIAL JUSTICE**
ADVANCING A GLOBAL LATINA/O PSYCHOLOGY AGENDA

PRESENTERS	TITLES	SESSION CODE	CONTENT CODE	TYPE	LOCATION	TIME
Rachel Navarro, Lisa Flores, Diana Silvensky	1. Testing a longitudinal social cognitive model of intended persistence with engineering students across gender and race/ethnicity	Understanding the Participation of Latina/os in the Engineering Pipeline S25	Educator; Researcher	Symposium	Alvarado G	10:00AM - 10:50AM
Lisa Flores, Rachel Navarro, Melissa Munoz	2. Transitioning to Industry: Effects of Race and Gender-Related Career Barriers and Engineering Self-Efficacy on Work Satisfaction among Latina/o Engineers					
Rebecca Gonzalez, Rachel Navarro, Lisa Flores	3. Stories of Persistence: A Qualitative Exploration of the Experiences of Latina/os in Engineering					
Chair: Lisa Flores Discussant: Ellen Hawley McWhirter						
Dianna Marisol González, Cynthia E. Guzmán	¿Quién yo? ¡No! Realizing the Servant- Leader Within	W15;	Advocate, ECP	Workshop	Fireplace Room	10:00AM - 12:00PM
Luis Angelo Gomez Riquelme	How to help LGBT Latina/o clients: Strategies and programs to guide counselors and psychologists	W8	2 CE Credit Practitioner	Workshop	Weavers	10:00AM - 12:00PM
Jeanett Castellanos, Jose Cervantes	Medicina Para El Espíritu via Shamanismo: Sanación Para Ellos/as Y Nosotros/as	W9	2 CE Credit Practitioner	Workshop	Turquoise	10:00AM - 12:00PM



SATURDAY MORNING: PROGRAM SESSION III

PRESENTERS	TITLES	SESSION CODE	CONTENT CODE	TYPE	LOCATION	TIME
Ryan Blucker	31. Interpersonal Conflict among Latinas/os: Integrating Emic and Etic Perspectives of Theory and Practice	R31-34	Researcher; Practitioner	Roundtable Discussions	Franciscan Ballroom	11:00AM - 11:50AM
Kristin Kenefick, Azara Santiago Rivera	32. Transformative Learning in Latin America					
Sylvia Rapini De Yatim	33. El uso de la Autorevelación (Self-Disclosure) por parte del Terapeuta Bilingüe con Clientes de Habla Hispana: Experiencias y Consideraciones Éticas.					
Michael Escamilla, Regina Armas, Brenda Castillo, Ricardo Pulido	34. Social, Psychological, and Subjective Wellbeing in Latinos					
1. Eduardo Morales	1. Immigration Challenges for Latino LGBTs	Cultural and Linguistic Competence within the Latino/a LGB Community S24	Practitioner; Researcher	Symposium	Alvarado C	11:00AM - 11:50AM
2. Ernesto Noam Lira	2. The Role of Spirituality for Latino Gay Men					
3. Rachel Reinders-Saeman	3. Bilingual Counseling with the LGBT Community					



**DREAMERS,
IMMIGRATION,
& SOCIAL JUSTICE**
ADVANCING A GLOBAL LATINA/O PSYCHOLOGY AGENDA

PRESENTERS	TITLES	SESSION CODE	CONTENT CODE	TYPE	LOCATION	TIME
Brieanne Kohrt	1. Quiero ser psicólogo bilingüe: Needs, paths, and challenges encountered by students seeking training in Spanish for mental health professionals	Development of the Bilingual Psychologist: Obstacles, Opportunities, and Future Directions for Training, Supervision, and Practice S23	Student; Educator	Symposium	Alvarado B	11:00AM - 11:50AM
Luis Vargas	2. The Process and Practice of Culturally Imbued Supervision for Students Serving Language Minority Clients: Myths, Models, and Meanings					
Artemio Brambila	3. Application of the Culturally Responsive Supervision Model to Inpatient Psychiatric Hospitals and Other Out of Home Placements for Youth and Families					
Pierluigi Mancini	4. What does a cultural and linguistically appropriate behavioral health center look like?					
David González, Camilo Ruggero	1. Measuring Depressive Symptoms in Spanish Speakers	Assessment Issues with Spanish-Speakers S28	Practitioner; Student	Symposium	Alvarado G	11:00AM - 11:50AM
Camilo Ruggero, David González, Andrew Shelton, Kathleen Bain, Jennifer Callahan, Keke Liu	2. Screening for Bipolar Disorder in Spanish-Speaking Clients: Pitfalls of Existing Approaches and Recommendations to Reduce Misdiagnosis					
David González, Eduardo Estevis	3. Neuropsychological Assessment of Spanish Speakers					



**DREAMERS,
IMMIGRATION,
& SOCIAL JUSTICE**
ADVANCING A GLOBAL LATINA/O PSYCHOLOGY AGENDA

PRESENTERS	TITLES	SESSION CODE	CONTENT CODE	TYPE	LOCATION	TIME
Jose Toro-Alfonso	1. Trans what? Acceptance of transgenders among university students	College Students P9	Researcher; Educator	Paper Session	Alvarado F	11:00AM - 11:50AM
Jasmin Llamas	2. Freshman Struggles: Role of Locus of Control on Intragroup Marginalization and Distress					
Eunice Lerma, Javier Vela, Stacey Gonzalez, Omar Duque, Leticia Cavazos	3. The Influence of Meaning in Life, Spirituality, and Parents' Education on Latina/o College Students' Hope					
Donna Castaneda, Denise Garcia, Cynthia Garcia	4. Physical and Mental Health among Latina/o Immigrant and Non-Immigrant College Students					
Andrea Romero, Soyeon Shim, Joyce Serido	5. Family Capital, Academic Satisfaction and Retention Among Latino Undergraduates					
Michael Paz	1. Cultural Responsiveness for School-Based Practitioners who work with Spanish-Speaking Parents and Students	Dynamic Dimensions of Working with Latino Children and their Families in Elementary Schools S41	Practitioner	Symposium	Alvarado H	11:00AM - 11:50AM
Gustavo Barcenas	2. Hablando el Idioma de los Niños: Play Therapy in Elementary Schools with Latino Spanish-Speaking Children					

SATURDAY LUNCH: KEYNOTE PRESENTATION & CONVERSATORIO

Carola Suárez-Orozco	Lunch & Keynote: Developmental Implications of Undocumented Status	K3	1 CE Credit Keynote Sponsored by APA Division 45	Keynote	Alvarado DE	12:00PM - 1:20PM
Carola Suárez-Orozco	Conversatorio with Carola Suárez-Orozco	C2		Conversatorio	Fireplace Room	1:30PM - 2:20PM



SATURDAY AFTERNOON POSTER SESSION

CODE	PRESENTATION TITLE	AUTHOR(S) & AFFILIATION
1	The Influence of Loneliness and Interpersonal Relations on Latina/o Adolescent Wellbeing	Dagoberto Heredia, Texas A&M University; Mayra Sanchez Gonzalez, Texas A&M University; Christine Rosner, Texas A&M University; Xiao He, Texas A&M University; Linda Castillo, Texas A&M University
2	Microaggressions and Latina/o Adolescents' School Connectedness	Eric Garcia, University of Oregon; Ellen Hawley McWhirter, University of Oregon; Nina Hidalgo, University of Oregon
3	Academic and Life Satisfaction Correlates of Traditional Gender Role Beliefs for Mexican American Adolescents	Ashley Martinez, Texas Tech University; Brandy Piña-Watson, Texas Tech University
4	Effects of a Brief Reading intervention for Spanish-English Bilingual Children	Amanda Clinton, Universidad de Puerto Rico
5	Understanding Latina/o College Students' Meaning in Life, Spirituality, and Subjective Happiness	Javier Vela, The University of Texas at Brownsville; Leticia Cavazos, The University of Texas at Brownsville; Stacey Gonzalez, The University of Texas at Brownsville; Omar Duque, The University of Texas at Brownsville; Megan Calvillo, The University of Texas at Brownsville
6	Sensitivity and specificity in three commonly used depression measures: Results from a Latina sample	Dellanira Garcia, University of San Francisco; Xiaoyu Bi, Veterans Affairs Hospital, Palo Alto & Stanford University; Cecilia Ayon, Arizona State University
7	The Role of Abuelos on Latina/o College Students Experiences	Katherine Martinez, UC IRVINE; Eliza Maria Pena, University of Southern California; Jeanett Castellanos, UC IRVINE
8	Examining Campus Climate, Microaggressions, Campus Connectedness, Ethnic Identity, and Stress Among College Students of Color	Shannon Chavez-Korell, University of Wisconsin-Milwaukee; Marisela López Flores, University of Wisconsin-Milwaukee; Rachel Reinders-Saeman, UW-Milwaukee; Lester Kern, University of Wisconsin-Milwaukee; Ernesto Noam Lira, University of Wisconsin-Milwaukee; Alina Alomá, University of Wisconsin-Milwaukee; Esmeralda León, University of Wisconsin-Milwaukee; Angela Lewis, University of Wisconsin-Milwaukee; Silvia Salas-Pizaña, University of Wisconsin-Milwaukee; Luis Altamirano, University of Wisconsin-Milwaukee
9	Experiences of Infidelity and Forgiveness of Latino College Students	Sandra Alfaro, University of La Verne; Tamara Obregon-Contreras, University of La Verne; Leticia Arellano-Morales, University of La Verne
10	Effects of Racial/Ethnic Microaggressions, Sociopolitical Development, and Protective Factors on Academic Persistence Intentions among Latina/o College Students	Cynthia Medina, University of California, Berkeley; Ellen Hawley McWhirter, University of Oregon; Benedict McWhirter, University of Oregon



CODE	PRESENTATION TITLE	AUTHOR(S) & AFFILIATION
11	College Students of Color Ethnic Identity Profiles influence on Social Connectedness and Campus Climate Views	Marisela López Flores, University of Wisconsin-Milwaukee; Alina Alomá, University of Wisconsin-Milwaukee; Ernesto Noam Lira, University of Wisconsin-Milwaukee; Rachel Reinders-Saeman, UW-Milwaukee; Angela Lewis, University of Wisconsin-Milwaukee; Lester Kern, University of Wisconsin-Milwaukee
12	Microaggressions and Social Cognitive Career Theory: A study on the career development of Latinas	Luisa Bonifacio, Teachers College, Columbia University; George Gushue, Teachers College, Columbia University
13	Quest Religiosity and Depressive Symptoms among Hispanic College Students: Purpose in Life as a Mediator	Adrian J. Bravo, Old Dominion University; Matthew Pearson, Center on Alcoholism, Substance Abuse, & Addictions
14	Hispanic and Anglo Clients Working with Hispanic or Anglo Counselors: Different Outcomes?	Cynthia Unger, New Mexico State University; Michael Waldo, New Mexico State University
15	Impact of Individual Counseling on Somatization and Hostility for Hispanic Female College Students	Cynthia Unger, New Mexico State University; Michael Waldo, New Mexico State University; Tamara Ulysse, Veteran's Administration Medical Center, Puerto Rico
16	Identifying CBT adaptations for low SES populations: A pilot study	Hillary Bell, Palo Alto University; Andrea Naranjo, Palo Alto University; Alinne Z. Barrera, Palo Alto University
17	The Machismo experience in Psychotherapy	Jesse Medrano, Graduate student at Pepperdine University
18	Environmental Stressors and Cultural Barriers and Their Effects on the Mental Health of Latina/Hispanic Women	Ernesto Alonso, California State University, San Bernardino; Arlene Castro, California State University, San Bernardino; Olga Amador, California State University, San Bernardino; Bryan Sanchez, California State University, San Bernardino; Manijeh Badiie, California State University, San Bernardino
19	Factors influencing attitudes towards seeking psychological help in Latina/o adults	Alina Alomá, University of Wisconsin-Milwaukee; Ernesto Noam Lira, University of Wisconsin-Milwaukee; Marisela López Flores, University of Wisconsin-Milwaukee; Esmeralda León, University of Wisconsin-Milwaukee; Silvia Salas-Pizaña, University of Wisconsin-Milwaukee; Luis Altamirano, University of Wisconsin-Milwaukee
20	Training the Next Generation: Considerations for the Training, Support, and Retainment of Latinas/os in Psychology	Vincenzo Teran, Cambridge Health Alliance/Harvard Medical School
21	Navigating Cultural Contexts: Development of a Brief Measure of Latina/o Bicultural Efficacy	Lisa Edwards, Marquette University; Francesca Lopez, University of Arizona



**DREAMERS,
IMMIGRATION,
& SOCIAL JUSTICE**
ADVANCING A GLOBAL LATINA/O PSYCHOLOGY AGENDA

CODE	PRESENTATION TITLE	AUTHOR(S) & AFFILIATION
22	The Wright Institute Sanctuary Project: An Innovative Training Program for Psy.D. students	Brenda Padilla, The Wright Institute
23	Bilingual Group Supervision and Training Impact on Psychology Trainees' Competence and Confidence	Natalie Carlos, Children's Hospital of Los Angeles; Veronica Chavez, Children's Hospital of Los Angeles; Irina Zamora, Children; Sara Sherer, Children's Hospital of Los Angeles
24	Cultural Value and Beliefs Among an Intimate Partner Violence Population	Kristina Rodriguez, California Lutheran University
25	¿Viste lo Qué Pasó Anoche en la Telenovela? Viewer Involvement Predicts Benevolent Sexism Among Latinas	Melek Yildiz Spinel, DePaul University; Irene Lopez, Kenyon College; Sarah Murnen, Kenyon College; Katherine Corker, Kenyon College
26	Sexual Violence and Coping Among Latina Survivors: A Review of the Literature	Danielle Quintero, University of Missouri
27	Hispanic LGB and Religious Identities: A Postmodern Narrative Study	Andrea Gonzalez, New Mexico State University
28	Representations of Gender, Skin Color, and Social Class in Telenovelas	Irene Lopez, Kenyon College; Melek Yildiz Spinel, DePaul University
29	Understanding Prospective School Counselors' Perceptions of Challenges that Latina/o Students Face	Liza Veliz, South Texas College; Javier Vela, The University of Texas at Brownsville; Stacey Gonzalez, The University of Texas at Brownsville; Megan Calvillo, The University of Texas at Brownsville



SATURDAY AFTERNOON: PROGRAM SESSION IV

PRESENTERS	TITLES	SESSION CODE	CONTENT CODE	TYPE	LOCATION	TIME
Hector Torres, Andrés J. Consoli	NLPA International Engagement Group & Presidential Initiative: Open meeting	M6	Conference Theme & Presidential Initiative	Meeting	Franciscan Ballroom	2:30PM - 3:20PM
Lynda Field, Shannon Chavez- Korell	She's From the Ghetto: Classism & the Latina/o Psychologist the Dialogue Continues	R2	ECP; Student; Practitioner	Roundtable Discussion	Fireplace Room	2:30PM - 3:20PM
Guadalupe Cruz, Marjory Vazquez, Denise Leon, Lisa Flores	1. The Influence of Community Perception and Acculturation on Latina/o Immigrants' Support Seeking	Latino Immigrant Integration in Rural Midwest Communities S29	Conference Theme & Presidential Initiative; Researcher	Symposium	Alvarado B	2:30PM - 3:20PM
Denise Leon, Marjory Vazquez, Guadalupe Cruz, Lisa Flores	2. Relations of Support Seeking and Life Satisfaction among Latina/o Immigrants in the Midwest					
Lisa Flores, Guadalupe Cruz Chair: Lisa Flores	3. Relationship between Cultural and Environmental Factors on Immigrants' Personal Well-Being and Perceptions of Children's Well-Being					



**DREAMERS,
IMMIGRATION,
& SOCIAL JUSTICE**
ADVANCING A GLOBAL LATINA/O PSYCHOLOGY AGENDA

PRESENTERS	TITLES	SESSION CODE	CONTENT CODE	TYPE	LOCATION	TIME
Carolyn Ponting, Daniela Recabarren	1. Examining Narratives: A Study of Gender and Duration of Untreated Psychosis in Mexico	A Latino Mental Health Summer Research Training Program in Mexico: Psychosis Research and Program Evaluation S33	Researcher	Symposium	Alvarado C	2:30PM - 3:20PM
Frank Sosa, Lynda lin	2. Enhancing Psychosis Literacy of Health Professional in Mexico					
Laura Garcia Cardona, Jaclyn Arencibia	3. Behavioral Assessment of the Social Competence of Caregivers and their Ill Relatives with Schizophrenia					
Steven Lopez, V. Nelly Salgado, Maria del Carmen Lara Munoz	4. Latino Mental Health Research Training in Mexico: A 10-Year Program					
Miguel Gallardo	1. Are psychological ethics culturally responsive? Considerations for research and practice with U.S. Latinas/os	Latina/o Psychology and non-Latina/o Ethics: Challenges and solutions for research on Latina/o psychology. S40	Researcher; Educator	Symposium	Alvarado DE	2:30PM - 3:20PM
Melanie M. Domenech Rodríguez	2. The dual challenge of applied psychological research with U.S. Latinas/os: Ensuring ethics and compliance.					
Ignacio David Acevedo-Polakovich	3. When participants become researchers: Ethical and compliance challenges and solutions for community-engaged psychological research with U.S. Latinas/os					



**DREAMERS,
IMMIGRATION,
& SOCIAL JUSTICE**
ADVANCING A GLOBAL LATINA/O PSYCHOLOGY AGENDA

PRESENTERS	TITLES	SESSION CODE	CONTENT CODE	TYPE	LOCATION	TIME
Miriam Camacho Valladares, Regina Armas	1. Resiliencia en mujeres mexicanas: un estudio transversal	Strengths and Stressors found among young mexicanas-important variables for generating culturally-significant psychological evaluations S44	Researcher	Symposium	Weavers	2:30PM - 3:20PM
Regina Armas	2. Resiliencia cultural y otros puntos a considerar en las evaluaciones psicologicas de mujeres indocumentadas en los Estados Unidos.					
Erendira Lopez-Garcia, Claudette Antuna	Forensic Psychological Evaluation in Immigration Cases: Assisting immigration officials and the court in the determination process	W18	2 CE Credit Practitioner	Workshop	Alvarado F	2:30PM - 4:30PM
Diana Mendez, Jesus Perez	Acculturative Stress and Latino Immigrants' Family Structure: Culturally-Sensitive Interventions	W14	2 CE Credit Practitioner	Workshop	Alvarado G	2:30PM - 4:30PM
Matthew Mock	Young Latinas/os and Their Families: Shining Lights on Strengths and Resilience in Context	W17	2 CE Credit Practitioner	Workshop	Alvarado H	2:30PM - 4:30PM
Eduardo Morales	Contextual Community Prevention-Built from the Ground Up: Incorporating Social Capital for Latino Gay Men	W6	2 CE Credit; Advocate	Workshop	Turquoise	2:30PM - 4:30PM
Zully Rivera-Ramos, Iris Carrillo, Carol Fonseca	Latina/o LGBTQ Safe Zone Workshop: The Brown Side of the Rainbow	W3	3 CE Credit; Advocate	Workshop	Potters	2:30PM - 5:30PM

SATURDAY AFTERNOON BREAK ~ 3:20PM - 3:40PM



SATURDAY AFTERNOON: PROGRAM SESSION V

PRESENTERS	TITLES	SESSION CODE	CONTENT CODE	TYPE	LOCATION	TIME
Anna Lopez	1. "Como si hubiera muerto:" Exploring the experiences of spouses of Mexican deportees	Across Borders: Challenges impacting Latino/a communities S17	Practitioner; Conference Theme & Presidential Initiative	Symposium	Alvarado B	3:40PM - 4:30PM
Anna Laura James	2. Exploring the psychological impact of the Mexican drug war on a border Mexican community					
Ivelisse Torres Fernandez	3. Addressing the Mental Health Needs of Children Impacted by the Violence in the US-Mexico Border					
Angela Gutierrez	1. Components of Formative Research to Inform Health Studies of Undocumented Immigrants	Improving the Quality of Health Research among Undocumented Immigrant Populations: Overcoming Challenges and Recommendations S32	Researcher, Conference Theme & Presidential Initiative	Symposium	Alvarado C	3:40PM - 4:30PM
Luz Garcini	2. Challenges and Recommendations for Conducting Formative Research with Undocumented Immigrants					
Elvia Lorena Navarro	3. Improving the Quality of Research with Undocumented Immigrant College Students					
Patricia Arredondo, Ignacio David Acevedo-Polakovich, Valerie Minchala	Student Scholarship Meeting	M5	Student	Meeting	Fireplace Room	3:40PM - 5:00PM



PRESENTERS	TITLES	SESSION CODE	CONTENT CODE	TYPE	LOCATION	TIME
Alinne Z. Barrera	1. Data from a global sample of pregnant women participating in an online prevention of postpartum depression intervention trial	Using technology-based research to provide maternal mental health resources to Latina women worldwide S19	Researcher	Symposium	Weavers	3:40PM - 4:30PM
Elizabeth Peters, Alinne Z. Barrera	2. Tracking depression symptoms during pregnancy using an Internet-based assessment					
Alex Kelman, Meagan Stanley, Alinne Z. Barrera	3. The development, implementation, and re-design of Internet-based tools for pregnant women					
Chair: Alinne Z. Barrera						

SATURDAY AFTERNOON: PROGRAM SESSION VI

Sumie Okazaki, Kevin Nadal	1. The Asian American Psychological Association: Alliance Member Association's History & Current Goals.	The Alliance of National Psychological Associations for Racial and Ethnic Equity: Who are we and what are our goals? S30	Advocate	Symposium	Alvarado B	4:40PM - 5:30PM
Cheryl Grills, Daryl Rowe	2. Association of Black Psychologist (ABPsi): Introduction to an Alliance Member					
Nadine Kaslow, Jennifer Kelly	3. American Psychological Association: An Alliance Partner					
Andrés Consoli, Lynda Field	4. National Latina/o Psychological Association: An Alliance Partner					
Jacque Gray, Carolyn Morris	5. The Society of Indian Psychologists (SIP): An Introduction to an Alliance Member					



**DREAMERS,
IMMIGRATION,
& SOCIAL JUSTICE**
ADVANCING A GLOBAL LATINA/O PSYCHOLOGY AGENDA

PRESENTERS	TITLES	SESSION CODE	CONTENT CODE	TYPE	LOCATION	TIME
Corin Ramos	1. Sí Se Puede: The Effect of Collective Angst and Identity on Group Activism among Latinos during the National Immigration Debate	Building a movement in the face of anti-immigrant legislation S27	Advocate, Conference Theme & Presidential Initiative	Symposium	Alvarado C	4:40PM - 5:30PM
Jamie Longazel	2. Movement Building in the Shadow of Anti-Immigrant Legislation: Barriers and Promises					
Sara Castro-Olivo, Robert Garcia	1. The Effects of a Culturally-Responsive Parenting Program on Latino Students' Social-Emotional, Physical, and Academic Outcomes	Interventions P11	Practitioner	Paper Session	Alvarado F	4:40PM - 5:30PM
Gregory Benson-Flórez, Alexandra Martinez	2. Culturally Adapted Group Therapy for Spanish Speaking Latino Parents					
Melissa Donovick, Brion Marquez, Ramon Concepcion, Yolanda Valenzuela, Anna McWhirter, Lisette Sanchez, Katelyn Anderson	3. Mis Hijos y Yo (My children and I) multi-media based, Spanish language, culturally relevant parenting education program for divorced or separated Latina/o families					
Lauren Utter	4. Primary Caregiver Deportation and Detention: A Therapeutic Workbook for Latino Children and Families					



**DREAMERS,
IMMIGRATION,
& SOCIAL JUSTICE**
ADVANCING A GLOBAL LATINA/O PSYCHOLOGY AGENDA

PRESENTERS	TITLES	SESSION CODE	CONTENT CODE	TYPE	LOCATION	TIME
Saandra Guzman	1. Parental Involvement in Schools: Recent Latino/a Immigrant Perspectives	Parental Involvement of Latino/a Parents: Perceptions of Recent Immigrant Parents and Teachers S39	Practitioner Educator	Symposium	Alvarado G	4:40PM - 5:30PM
Diana Diaz Chair: Heejung Chun	2. Teachers' Perception of Latino/a Parental Involvement					
Teresa Lopez-Castro	1. On TRACC: Mentoring and Training of Ethnic and Racial Minorities for Careers in Addiction Research	Connecting the Dots: Latina/o Recruitment, Training, and Professional Identity Development S31	Educator	Symposium	Alvarado H	4:40PM - 5:30PM
Diana Punales	2. Being in Becoming: A Supervision and Practicum Training Model for Latina/o Psychologists					
Malena Vinocur, Wendy Carolina Franco	3. Coming Together: Consolidating a Multicultural Professional Identity through Clinical Collaboration					



**DREAMERS,
IMMIGRATION,
& SOCIAL JUSTICE**
ADVANCING A GLOBAL LATINA/O PSYCHOLOGY AGENDA

PRESENTERS	TITLES	SESSION CODE	CONTENT CODE	TYPE	LOCATION	TIME
Melissa Rodriguez, Tiffany Loggins, Jessica Martin	1. Fuertes y Valientes: Narrative Therapy Platicas with Latina Military Service Members	Concientización in a Latina/o Psychology Course:	Practitioner	Symposium	Weavers	4:40PM - 5:30PM
Jacqueline Coppock, Melissa Cole, Ezequiel Peña	2. HIV-positive Latinos Grieving an AIDS-related Loss: The Need for Culturally Sensitive Therapeutic Interventions	Pedagogical Strategies for Exploring Diversity Within Latina/o Communities				
Lacey Moffatt, Jeremy Gallas	3. Entrusting a Loved One to the Care of Another: ¿Quién Cuidará a Los Padres?	S42				
Chair: Ezequiel Peña Discussant: Ezequiel Peña						
Sara Buckingham	1. "Our Differences Don't Separate Us:" Navigating Acculturation Gaps through Family Resilience Processes	Acculturation and Identity Research	Researcher, Conference Theme & Presidential Initiative	Paper Session	Turquoise	4:40PM - 5:30PM
Carlos Arturo Clavijo Meneses, Miriam Camacho Valladares, Amanda Arevalo, Guadalupe Medina Hernández, Sotero Moreno Camacho	2. Deseabilidad social en la pareja en jóvenes mexicanos con diferente orientación sexual: un estudio transversal					
3. Cristalís Capielo, Edward Delgado-Romero, Melanie M. Domenech Rodríguez	3. A Bilinear Three-dimensional Model of Acculturation for Central Florida Puerto Ricans					



**DREAMERS,
IMMIGRATION,
& SOCIAL JUSTICE**
ADVANCING A GLOBAL LATINA/O PSYCHOLOGY AGENDA

SATURDAY EVENING: NOCHE DE GALA: AWARDS, RECOGNITIONS, DINNER, & DANCE

PRESENTERS	TITLES	SESSION CODE	CONTENT CODE	TYPE	LOCATION	TIME
NLPA & Guests	Noche de Gala Featuring Café Mocha!	Awards, Recognitions, Dinner, & Dance		Social	Alvarado DE	7:00PM - 1:00AM

SUNDAY | OCTOBER 26, 2014

Advance Registration Required	Community Engagement Event	Los Jardines Institute			Meet in Lobby	8:30AM - 12:00PM
Alliance Members	Annual Meeting of The Alliance of National Psychological Associations for Racial and Ethnic Equity	M7		Meeting	Fireplace Room	8:30AM - 5:00PM



RELIVE HISTORY

EXPERIENCE
HOSPITALITY

BE INSPIRED...

WHERE MEETINGS & CONVENTIONS MEET
CULTURE AND DIVERSITY

The Albuquerque Hispano Chamber of Commerce specializes in Hispanic and Native American conventions and events.

Let our department connect your attendees with a cultural experience.



ALBUQUERQUE



1-800-754-4620

www.ahcnm.org • email: ABQtourism@ahcnm.org



Are you ready to transform
lives and ideas?

The Morgridge College of Education has a range of offerings in Child, Family and School Psychology to fit your next step.

Prepare to be inspired and engaged in real life learning.

Our Child Family and School Psychology PhD program is NASP Accredited and has a 100% job placement rate within 6 months of graduation in the field.



UNIVERSITY of
DENVER

MORGRIDGE COLLEGE OF EDUCATION

www.morgridge.du.edu

303-871-2509 | 800-835-1607



ATTENDEE DIRECTORY

THE ATTENDEES LISTED BELOW GAVE WRITTEN PERMISSION FOR THEIR INCLUSION. DIRECTORY CURRENT AS OF OCTOBER 8, 2014.

FIRST NAME	LAST NAME	AFFILIATION
I. David	Acevedo	Central Michigan University
Suzana	Adams	
Eve	Adams	New Mexico State University
Martin	Alcala	Universidad Michoacana de San Nicolas de Hidalgo
Alina	Aloma	University of Wisconsin-Milwaukee
Ernesto	Alonso	CSUSB
Elizabeth	Altamirano	University of Central Florida
Melissa	Alvarado	Walden Univeristy
Alvin	Alvarez	San Francisco State University
Olga	Amador	California State University, San Bernardino
Edson	Andrade	CSUSB
Marie-Christine	Andre	Suffolk University
Anahi	Angel	CSUSB
Claudette	Antuna	Private Practice
Miguel	Arciniega	Arizona State University
Jaclyn	Arencibia	University of Southern California
Maria	Arizaga	New Mexico State University
Regina	Armas	U of California, San Francisco
Fabiola	Audibert	Nova Southeastern University
Evelyn	Ayala	CSU San Bernardino
Cecilia	Ayon	Arizona State University
Manijeh	Badiee	California State University San Bernardino
Carissa	Balderas	University of Georgia
Gustavo	Barcenas	University of North Texas



ATTENDEE DIRECTORY

THE ATTENDEES LISTED BELOW GAVE WRITTEN PERMISSION FOR THEIR INCLUSION. DIRECTORY CURRENT AS OF OCTOBER 8, 2014.

FIRST NAME	LAST NAME	AFFILIATION
Alinne	Barrera	Palo Alto University
Ana	Baumann	Washington University in St. Louis
Luis Antonio	Becerra	California School of Professional Psychology at Alliant International University
Hillary	Bell	Pacific Graduate School of Psychology/Palo Alto University
Mari Carmen	Bennasar	Massachusetts School of Professional Psychology
Gregory	Benson-Flórez	Arizona School of Professional Psychology
Darren	Bernal	UWF
Ryan	Blucker	University of Oklahoma College of Medicine, Pediatrics
Luisa	Bonifacio	Teachers College, Columbia University
Raquel	Botello	Iowa State University
Adrian	Bravo	Old Dominion University
Julio	Brionez	
Jonathan	Briseno	Texas A&M Intl University
Sara	Buckingham	U. of Maryland, Baltimore County
Mariel	Buque	Teachers College, Columbia University
Cristina	Bustos	Ft Belvoir Community Hospital/Chicago School of Professional Psychology
Leonora	Cabrera	MA LMHC
German	Cadenas	Arizona State University
Lizeth	Camacho	Michigan State University
Cristalis	Capielo	The University of Georgia
Esteban	Cardemil	Clark University
Omara	Cardoza	Kean University
Natalie	Carlos	Children's Hospital of Los Angeles



ATTENDEE DIRECTORY

THE ATTENDEES LISTED BELOW GAVE WRITTEN PERMISSION FOR THEIR INCLUSION. DIRECTORY CURRENT AS OF OCTOBER 8, 2014.

FIRST NAME	LAST NAME	AFFILIATION
Megan	Carney	University of Missouri
Blanca	Caro	Washington State University
Iris	Carrillo	Texas A&M University
Elizabeth	Carter	Palo Alto University
Donna	Castaneda	San Diego State University-Imperial Valley
Carrie	Castaneda-Sound	Pepperdine University
Jeanett	Castellanos	UC Irvine
Linda	Castillo	Texas A&M University
Brenda	Castillo	TTUHSC El Paso
Janice	Castro	University of Nebraska-Lincoln
Gena	Castro Rodriguez	California Institute of Integral Studies
Leticia		Univ. of Texas-Brownsville
Javier	Cavazos	University of Texas at Brownsville
Alison	Cerezo	San Francisco State University
Joseph	Cervantes	California State University, Fullerton
Tom	Chavez	University of New Mexico
Shannon	Chavez-Korell	University of Wisconsin-Milwaukee
Denise	Chavira	UCLA
Heejung	Chun	New Mexico State University
Jesus	Cisneros	Arizona State University
Andrés	Consoli	UC Santa Barbara
Gabriela	Contreras	CSUSB
Robert	Cook	Private Practice
Jacqueline	Coppock	Our Lady of the Lake



ATTENDEE DIRECTORY

THE ATTENDEES LISTED BELOW GAVE WRITTEN PERMISSION FOR THEIR INCLUSION. DIRECTORY CURRENT AS OF OCTOBER 8, 2014.

FIRST NAME	LAST NAME	AFFILIATION
Julissa	Cortes	Pepperdine University
Laura	Cote Gonzalez	Denver Health Medical Center
Guadalupe	Cruz	University of Missouri-Columbia
Jessica	Daniel	Boston Children's
Lupe Carvajal	Dannels	Diablo Valley College
Raul	de la Cruz	New Mexico State University, Counseling Psychology Program
Rita	Delgado	Diablo Valley College
Marla	Delgado	University of Wisconsin-Madison
Edward	Delgado-Romero	University of Georgia
Elisa	DeVargas	University of Oregon
Ma. Isabel	Diaz	University of California, Irvine
René	Díaz-Lefebvre	Glendale Community College North
Melanie	Domenech Rodriguez	Utah State University
Marianela	Dornhecker	Texas A&M
Mihaela	Dranoff	Montclair State University
Mary	Duenas	University of Wisconsin-Madison
Omar	Duque	University of Texas at Brownsville
Lisa	Edwards	Marquette University
Michael	Escamilla	TTUHSC El Paso
Mayra	Estrada	Pepperdine Student
Alejandrina	Estrada	John F. Kennedy University
Minnah	Farook	University of Kentucky
Lou	Felipe	University of San Francisco
Ana Michelle	Fernández	Ponce School of Medicine & Health Sciences



**DREAMERS,
IMMIGRATION,
& SOCIAL JUSTICE**
ADVANCING A GLOBAL LATINA/O PSYCHOLOGY AGENDA

ATTENDEE DIRECTORY

THE ATTENDEES LISTED BELOW GAVE WRITTEN PERMISSION FOR THEIR INCLUSION. DIRECTORY CURRENT AS OF OCTOBER 8, 2014.

FIRST NAME	LAST NAME	AFFILIATION
Mercedes	Fernandez Oromendia	University of California, Santa Barbara
Susana	Ferradas	Howard University
Lynda	Field	Suffolk University
Alberto	Figueroa-Garcia	APA OEMA
Elena	Flores	University of San Francisco
Lisa	Flores	University of Missouri
Yolanda	Flores Niemann	University of North Texas
Carol	Fonseca	New Mexico State University, Psychology Resident
Elizabeth	Fraga	Teachers College, Columbia University
Wendy Carolina	Franco	PhD Candidate, City College CUNY
Veronica	Franco	University of California, Irvine
Milton	Fuentes	The Chicago School of Professional Psychology
Jacqueline	Fuentes	University of Oregon
Miguel	Gallardo	Pepperdine University
Flor de Maria	Gamboa	Universidad Michoacana de San Nicolas de Hidalgo
Jadig	Garcia	Suffolk University
Eric	Garcia	University of Oregon
Dellanira	Garcia	University of San Francisco
Yolanda	Garcia	Northern Arizona University
Laura M.	Garcia Cardona	University of Southern California
Luz	Garcini	SDSU/UCSD
Linda	Gates	Chatham University
Eleanor	Gil-Kashiwabara	
Judith	Glassgold	APA



ATTENDEE DIRECTORY

THE ATTENDEES LISTED BELOW GAVE WRITTEN PERMISSION FOR THEIR INCLUSION. DIRECTORY CURRENT AS OF OCTOBER 8, 2014.

FIRST NAME	LAST NAME	AFFILIATION
Luis	Gomez	Assistant Professor
Maria Pilar	Gomez-Marmolejo	Pepperdine University
Ricardo	Gonzales	New Mexico Psychological Association
Stacey	Gonzalez	University Texas at Brownsville
Araceli	Gonzalez	California State University, Long Beach
David	González	South Texas VA
Connie	Gould	Albuquerque
Julii	Green	CSPP/AIU, San Diego
Cheryl	Grills	Loyola Marymount University
Rut	Gubkin	Independent practitioner
Omar	Gudino	University of Denver
Martha S.	Guerra	Our Lady of the Lake University
Samuel	Guerrero	University of Wisconsin-Madison
Angela	Gutierrez	San Diego State University / University California San Diego
Cynthia E.	Guzmán	Independent Practice- Albuquerque, NM
Xiao	He	Texas A&M University
Mary	Heppner	University of Missouri
Puncky	Heppner	University of Missouri
Dagoberto	Heredia	Texas A&M University
Herminia	Hernandez	The Wright Institute
Omyda	Hernandez	Pacifica Graduate Inst.
Rafael	Hernandez	Cal State Univ San Marcos
kelley	Hershman	Universidad de California, Santa Barbara
Melanie	Heto	University of Denver



**DREAMERS,
IMMIGRATION,
& SOCIAL JUSTICE**
ADVANCING A GLOBAL LATINA/O PSYCHOLOGY AGENDA

ATTENDEE DIRECTORY

THE ATTENDEES LISTED BELOW GAVE WRITTEN PERMISSION FOR THEIR INCLUSION. DIRECTORY CURRENT AS OF OCTOBER 8, 2014.

FIRST NAME	LAST NAME	AFFILIATION
Nina	Hidalgo	University of Oregon
Belinda	Hinojos	University of Nebraska-Lincoln
Tracie	Hitter	New Mexico State University
Mónica	Hurtado-León	John F. Kennedy University
Andrea	Iglesias	University of Virginia
Arpana	Inman	Lehigh University
Maria	Islas-Lopez	University of Denver
Daniela	Jaramillo	North Shore Psychotherapy Associates
Ericka	Jenifer	ABPsi
Carolina	Jimenez	University of Houston
Monique	Jiménez	Adler School of Professional Psychology
Catarina	Juan Simon	Alliant International University - California School of Professional Psychology Los Angeles
Marlen	Kanagui-Muñoz	Kaiser Permanente, East Bay
Susan	Kaneshiro	OC Counseling & Psychological Services
Marcia	Kearns	University of Missouri
Alex	Kelman	Palo Alto University
Kristin	Kenefick	The Chicago School of Prof Psychology
Brieanne	Kohrt	Emory University
Shahana	Koslofsky	Pacific University
Ohyoung	Kwon	Lehigh University
Denise	Leon	University of Missouri-Columbia
Eunice	Lerma	University of Texas at Brownsville
Lynda	Lin	University of Pennsylvania



ATTENDEE DIRECTORY

THE ATTENDEES LISTED BELOW GAVE WRITTEN PERMISSION FOR THEIR INCLUSION. DIRECTORY CURRENT AS OF OCTOBER 8, 2014.

FIRST NAME	LAST NAME	AFFILIATION
Ernesto	Lira	University of Wisconsin-Milwaukee
Jamie	Longazel	University of Dayton
Virginia	Longoria	New Mexico State University
Steven	Lopez	Dept of Psychology, University of Southern California
Irene	Lopez	Kenyon College
Marisela	Lopez	University of Wisconsin-Milwaukee
Gabriela	Lopez	Our Lady of the Lake University
Anna	Lopez	New Mexico State University
Erendira	Lopez-Garcia	Wright State University
Yoseline	Lopez-Marroquin	AUSB Doctoral Student
Suliana	Lutin	Lutin Law Group
Antonio	Maldonado	Universidad de Puerto Rico
Waleska	Maldonado Navedo	Universidad de Puerto Rico
Pierluigi	Mancini	CETPA, Inc.
Jorge	Marquez	Univ. of Texas at El Paso
William	Martinez	DePaul University
Elizabeth	Martinez	University of Wisconsin-Madison
Kenneth	Martinez	American Institutes for Research
Katherine	Martinez	UC Irvine
Ashley	Martinez	Texas Tech University
Brian	McNeill	Washington State University
Benedict	McWhirter	University of Oregon
Ellen	McWhirter	University of Oregon
Anna Cecilia	McWhirter	



ATTENDEE DIRECTORY

THE ATTENDEES LISTED BELOW GAVE WRITTEN PERMISSION FOR THEIR INCLUSION. DIRECTORY CURRENT AS OF OCTOBER 8, 2014.

FIRST NAME	LAST NAME	AFFILIATION
Araceli	Mejia	Cal State Northridge
Diana	Mendez	University of Miami Miller School of Medicine
Narolyn	Mendez	Teachers College, Columbia University
Jennifer	Merrifield	University of Georgia
Carolina	Meza	California School of Professional Psychology
Valerie	Minchala	California State University, Fullerton
Laura	Minero	University of Wisconsin - Madison
Lucina	Miranda	Kaiser Permanente
Alex	Miranda	California Lutheran University
Marie	Miville	Teachers Coll, Columbia Univ
Eduardo	Morales	CSPP-SF of Alliant International University
Monica	Moreno Anguas	The University of Arizona
Melissa	Morgan Consoli	University of California Santa Barbara
John	Munoz	William Alanson White Institute
Melissa	Muñoz	University of Missouri
Gabriela A.	Nagy	University of Wisconsin - Milwaukee
Natasha	Najar	Marquette University
Andrea	Naranjo	Palo Alto University
Melvin	Navarro	County of Orange Health Care Agency, CA
Jose	Navarro	Transforming Life Center, inc.
Rachel	Navarro	University of North Dakota
Jose	Navarro	California State University, San Bernardino
Larissa	Niec	Central Michigan University
Marissa	Nunes	Fuller Theological Seminary, School of Psychology



ATTENDEE DIRECTORY

THE ATTENDEES LISTED BELOW GAVE WRITTEN PERMISSION FOR THEIR INCLUSION. DIRECTORY CURRENT AS OF OCTOBER 8, 2014.

FIRST NAME	LAST NAME	AFFILIATION
Samuel	Nunez	Philadelphia College of Osteopathic Medicine
Gabriela	Nunez	Our Lady of the Lake University
Sumie	Okazaki	New York University
Roger	Olivarri, JR.	Austin Child Guidance Center
Angela	Orfield	Blue Cross of MN
Michelle	Orozco	California State University, San Bernardino
Brenda	Padilla	The Wright Institute
Claudia	Padilla	San Francisco State University
Kathleen	Padilla	(NMVAHCS) New Mexico VA Health Care Service
Eligio	Padilla	(NMVAHCS) New Mexico VA Health Care Service
Lisa	Padilla-Eaton	UNM
Margarita	Paredes	Private Practice
Angela	Patino Medrano	Alliant International University-CSFS
Michael	Paz	University of North Texas
Matthew	Pearson	CASAA, UNM
Juan	Pena	San Diego State University
Ezequiel	Peña	Our Lady of the Lake University
Jesus	Perez	Citrus Health Network, Inc.
Wade	Petree	Our Lady of the Lake University
Brandy	Piña-Watson	Texas Tech University
Anabel	Plasencia	CSPP
Carolyn	Ponting	UCLA Semel Institute
Loreto	Prieto	Iowa State University
Diana	Punales Morejon	Columbia U. Med. Ctr/CCNY



ATTENDEE DIRECTORY

THE ATTENDEES LISTED BELOW GAVE WRITTEN PERMISSION FOR THEIR INCLUSION. DIRECTORY CURRENT AS OF OCTOBER 8, 2014.

FIRST NAME	LAST NAME	AFFILIATION
Verónica	Rabelo	University of Michigan
Alyssa	Ramirez	University of Wisconsin-Madison
Manuel	Ramirez III	University of Texas at Austin
Corin	Ramos	University of Texas, El Paso
Alíxida	Ramos-Pibernus	Ponce School of Medicine & Health Sciences
Lucila	Ramos-Sánchez	Santa Clara University
Sylvia	Rapini De Yatim	Our Lady of the Lake University
Daniela	Recabarren	The University of Tennessee
Rachel	Reinders-Saeman	UW-Milwaukee
Ernesto	Reza	Arizona School of Professional Psychology
Carlos	Rivera	Suffolk University
Zully	Rivera-Ramos	University of North Florida
Eliut	Rivera-Segarra	Ponce School of Medicine & Health Sciences
Rosanna	Rivero	Pepperdine University
Sally	Robles	
Jose	Rodas	University of Arizona
Leidybeth	Rodriguez	Jackson Memorial Hospital
Rebecca	Rodriguez	Georgia State University
Richard	Rodriguez	Private Practice
Cesar	Rodriguez	Pepperdine Aliento
Norma	Rodriguez	Pitzer College
Juan	Rodriguez	Mission Family Center
Oscar	Rojas Perez	University of Missouri-Columbia
Bryan	Rojas-Arauz	San Francisco State University



ATTENDEE DIRECTORY

THE ATTENDEES LISTED BELOW GAVE WRITTEN PERMISSION FOR THEIR INCLUSION. DIRECTORY CURRENT AS OF OCTOBER 8, 2014.

FIRST NAME	LAST NAME	AFFILIATION
Ana	Romero	University of California, Santa Barbara
Andrea	Romero	University of Arizona
Theresa	Rosner-Salazar	(NMVAHCS) New Mexico VA Health Care Service
Shelley	Ruelas-Bischoff	CSU Northridge
Glenda	Russell	University of Colorado
Diana	Saal, Ph.D.	Developmental and Multicultural Consultant
Joanne	Salas	Texas State University
Silvia	Salas	University of Wisconsin-Milwaukee
Morgan	Sammons	National Register of Health Service Psychologists
Bryan	Sanchez	CSUSB
Delida	Sanchez	University of Texas at Austin
Lisette	Sanchez	University of Oregon
Mayra	Sanchez Gonzalez	Texas A&M University
Lisa	Sanchez-Johnsen	University of Illinois at Chicago
Marisol	Santalla	The Chicago School of Professional Psychology
Azara	Santiago-Rivera	The Chicago School of Professional Psychology
William	Sapigao	San Francisco State University
Tiffany	Schiffner	PsychCare Services
Lisa	Schulz	University of North Texas
Josephine	Serrata	National Latin@ Network
Joshua	Sheltzer	UC Santa Barbara
Michelle	Silva	Yale School of Medicine
Diana	Slivensky	University of North Dakota
Bernadette	Solorzano	Our Lady of the Lake University



**DREAMERS,
IMMIGRATION,
& SOCIAL JUSTICE**
ADVANCING A GLOBAL LATINA/O PSYCHOLOGY AGENDA

ATTENDEE DIRECTORY

THE ATTENDEES LISTED BELOW GAVE WRITTEN PERMISSION FOR THEIR INCLUSION. DIRECTORY CURRENT AS OF OCTOBER 8, 2014.

FIRST NAME	LAST NAME	AFFILIATION
Frank	Sosa	Reed College
Lisa	Spanierman	Arizona State University
Jeanette	Spring	OLLU
Rachel	Stein	UC Santa Barbara
Kee	Straits	TLC Transformations, LLC
Josune	Sullivan	CHAC
Vincenzo	Teran	Cambridge Hospital
Nadia	Thalji	Pacifica Graduate Institute - PhD Clinical Psychology
Jose	Toro-Alfonso	University of Puerto Rico
Eliseo	Torres	University of New Mexico
Hector	Torres	The Chicago School of Professional Psychology
Lucas	Torres	Marquette University
Ivelisse	Torres Fernandez	New Mexico State University
Margaret	Trummer	University of Missouri-Kansas City
Monica	Ulibarri	University of California, San Diego
Adriana	Umaña-Taylor	Arizona State University
Emily	Unzueta	UCSB
Lauren	Utter	Yale University
John	Valenzuela	Pacifica Graduate Institute
Yolanda	Valenzuela	University of Oregon
Luis	Vargas	University of New Mexico
Michelle	Varon	Utah State University
Melba	Vasquez	Independent Practice, Austin, TX
Marjory	Vazquez	University of Missouri



**DREAMERS,
IMMIGRATION,
& SOCIAL JUSTICE**
ADVANCING A GLOBAL LATINA/O PSYCHOLOGY AGENDA

ATTENDEE DIRECTORY

THE ATTENDEES LISTED BELOW GAVE WRITTEN PERMISSION FOR THEIR INCLUSION. DIRECTORY CURRENT AS OF OCTOBER 8, 2014.

FIRST NAME	LAST NAME	AFFILIATION
Miguel	Vazquez	Iniciativa Comunitaria
Anayeli	Vazquez Gonzalez	CSUSB DREAM TEAM
Liza	Veliz	South Texas College
Maribel	Villavicencio-Colón	University of Puerto Rico, Rio Piedras Campus
Malena	Vinocur	Maimonides Medical Center
Amanda	Wetegrove-Romine	Our Lady of the Lake University
Jorge	Wong	Asian Americans for Community Involvement
Carolina	Yahne	University of New Mexico
Melek	Yildiz Spinel	DePaul University
Esmeralda	Zamudio	CSPP-Alliant International University
Angela	Zapata	Marquette University



**DREAMERS,
IMMIGRATION,
& SOCIAL JUSTICE**
ADVANCING A GLOBAL LATINA/O PSYCHOLOGY AGENDA

NOTES



College of Education

Counseling & Educational Psychology

Transforming Lives

The department of **Counseling & Educational Psychology** promotes education and human development across the life span by providing graduate training in direct provision of counseling and psychological services, research, and teaching. The department offers the following degrees:

Undergraduate in Counseling and Educational Psychology

Doctorate (Ph.D.) in Counseling Psychology - accredited by the American Psychological Association (APA) following the 'scientist-practitioner model.'

Clinical Psychopharmacology Program - Offered by the Department of Counseling and Educational Psychology and the Department of Special Education at New Mexico State University in collaboration with the Southwestern Institute for the Advancement of Psychotherapy.

Specialist in Education (Ed.S.) in School Psychology - accredited by the National Association of School Psychologist (NASP) following the 'scientist-practitioner model.'

Masters of Arts Degree (MA) - accredited in mental health counseling by the Council for Accrediting of Counseling and Related Educational Programs (CACREP).

Minor in Counseling and Educational Psychology - The CEP Minor is for students preparing to enter one of the helping professions such as psychology, education, social work, criminal justice, nursing, and family and consumer sciences.

Please contact our Program Coordinator, Norma Arrieta at 575-646-5485 or narrieta@nmsu.edu to get more information about the Counseling & Educational Psychology Department.

HOTEL MAP

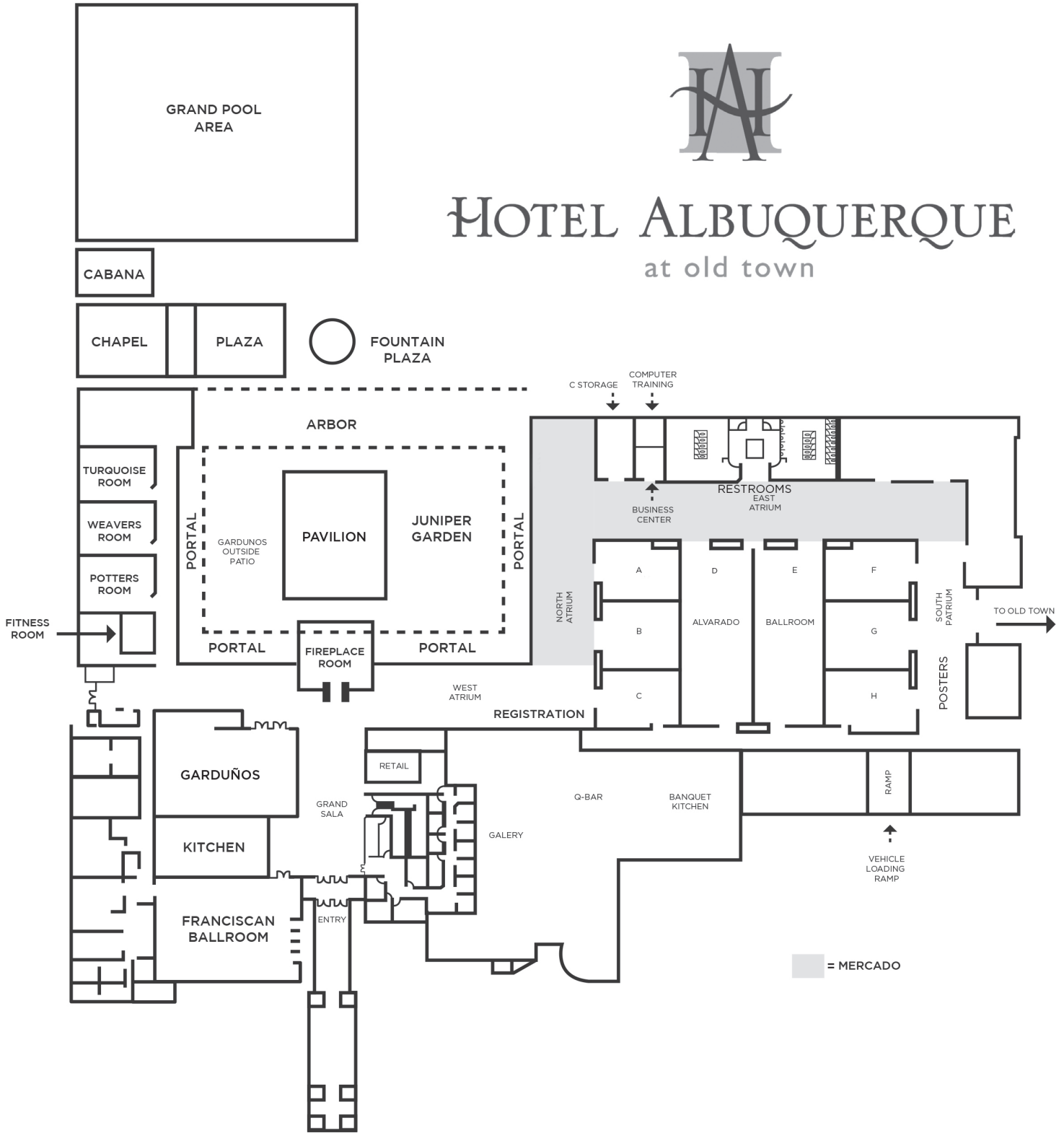



Make a difference.

At Teachers College, Columbia University we believe in the power of educators to excite, inspire and advocate for positive change in the world.

Unite your passion and purpose in one of our graduate-level programs and effect positive change in the fields of education, health, policy or psychology.

TEACHERS COLLEGE COLUMBIA UNIVERSITY
GRADUATE AND PROFESSIONAL SCHOOL OF EDUCATION

Programs with Purpose • Students with Vision
www.tc.columbia.edu/admission

